

# ADVANCED TECHNOLOGY

*High Quality  
Safe Solution*

[www.dayman.com.tr](http://www.dayman.com.tr)

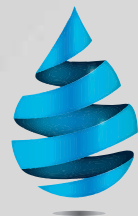

**Dayman®**

Teknik Yapı Kimyasalları



# DAYMAN

Usage areas of the Dayman :

Wet areas, retaining walls, leachate conditions, in the protection of the building and the building elements which has permanent or temporary water pressure or insulation, in order to stick the insulation and drainage plates.

Wet areas, retaining walls, leachate conditions, in the protection of the building and the building elements which has permanent or temporary water pressure or insulation, in order to stick the insulation and drainage plates.

”

WATER INSULATION SYSTEMS AND PRODUCT DETERMINATIONS .....	4
DETAILS .....	10
<b>PRODUCTS WHICH CONTAINS BITUMEN .....</b>	<b>23</b>
BITUMEN PLUS - 300 .....	24
BITUMEN PLUS - 302 .....	25
BITUMEN - 303 .....	26
BITUMEN PR - 304 .....	27
<b>PRODUCTS WHICH CONTAINS MINERAL .....</b>	<b>29</b>
CRYSTA - 404 .....	30
CRYSTA PLUS 2K - 405 .....	31
D-LASTIC - 424 .....	32
D-LASTIC SUPER UV - 426 .....	32
D-LASTIC PLUS - 425 .....	33
D-LASTIC SUPER 430 .....	33
D-LASTIC SUPER X - 427 .....	34
W-STOP - 440 .....	35
W-STOP SPEED - 441 .....	35
<b>WATER INSULATION PRODUCTS WHICH CONTAINS RESIN .....</b>	<b>37</b>
AQUAFLEX - 200 .....	38
AQUAFLEX UV - 202 .....	38
COOL ROOF - 607 .....	39
COOL ROOF ALM - 608 .....	39
AQUAPOL PR - 800 .....	40
AQUAPOL PR WT - 801 .....	40
AQUAPOL - 810 .....	41
AQUAPOL UV - 811 .....	41
BITUMEPOL - 812 .....	42

## CONTENTS

---

AQUAPOL 2K - 813.....	42
AQUAPOL TRANS - 814.....	43
AQUAPOL TRANS - 815.....	43
AQUA HIBRIT - 1001 .....	43
AQUA HIBRIT TRANS - 1002.....	44
PURSIS - 833 .....	44
<b>REPAIR MORTAR .....</b>	<b>47</b>
REPAIR - 904 .....	48
REPAIR PLUS - 905 .....	49
D-LEVEL - 750 .....	50
EPO MORTAR - 855.....	50
EPO GROUT - 858 .....	50
D-GROUT - 901 .....	51
D-GROUT SPEED - 902 .....	51
 FLOOR PRODUCTS WHICH CONTAINS CONCRATE .....	 53
HARD C - 700 .....	54
HARD C - 701 .....	54
HARD C - 702 .....	55
AC-CURE - 710 .....	55
P - CURE - 711.....	55
DECO C - 740 .....	56
DECO C POWER - 742 .....	56
DECO C FINIFH - 743.....	57
 EPOXY CONTENT PRODUCTS .....	 59
EPO-PR - 850 .....	60
EPO PR WT - 851 .....	60
EPO SELF - 854.....	61
EPO SAND - 860 .....	61
EPO SAND - 856 .....	61
EPO PAINT - 852 .....	62
EPO PAINT TX - 853.....	63

SERAMIC STICKS AND JOINT FILLERS .....	65
CERA-CEM - 908 .....	66
CERA-CEM PLUS - 909 .....	66
CERA-CEM FLEX - 910 .....	67
CERA-CEM FLEX-W - 911 .....	67
CERA-CEM FLEX 2K - 912 .....	68
CERA EPO - 915 .....	68
CERA FUGA - 913 .....	69
CERA FUGA FLEX- 914 .....	69
MORTAR ADDICTIVES .....	71
VISCO C - 501 .....	72
LATEX C - 502 .....	72
CRYSTA C - 503 .....	73
INSULATION SYSTEMS .....	75
D-THERM - 550 .....	76
D-THERM - 557 .....	76
D-THERM - 2810 .....	76
D-THERM - 559 .....	76
D-THERM - 551 .....	77
D-THERM - 552 .....	77
D-THERM - 553 .....	77
D-THERM - 554 .....	77
D-THERM - 555 .....	78
D-THERM - 556 .....	78

## CONTENTS

---

<b>SUBSUDERY PRODUCTS.....</b>	<b>81</b>
D-TEX 50 - 2800 .....	82
AQUATEX - 2700 .....	82
DK 100 - 2900 .....	83
TEX BAND - 2910 .....	83
D-BAND ST 100/200 - 2500 .....	84
D-BAND 120-2600 .....	84
D-BAND 120 AR - 2610 .....	84
D-BAND 20/25/30/40 .....	85
AQUABAND AC 2310-2311 .....	85
AQUABAND BT 10x20 - 20x25 .....	85
PU SEAL 600-2100 .....	86
PU SEAL PRO 2K - 2200.....	86
PU SEAL PR 150 .....	86
PU SEAL PR 160 .....	86
 <b>PRIVATE COLOURS AND PRIMERS.....</b>	 <b>89</b>
AQUAWALL - 606 .....	90
MOLD PAINT - 609 .....	91
MOLD PAINT SOL - 621 .....	91
GUARD FIRE - 610 .....	91
FLOOR PAINT - 611 .....	92
FLOOR PAINT X- 622 .....	92
ROAD PAINT - 612.....	93
COURT PAINT - 613.....	93
THERMAL PAINT METAL - 614 .....	94
THERMAL PAINT CONCRETE - 620 .....	94
D-NANO - 615.....	94
MOLD OIL - 616 .....	95
LEVEL PR - 617 .....	95
ST PRIMER - 619 .....	95

ANCHOR - INJECTION - ACESSORIES AND USAGE PRODUCTS .....	97
BOND EPO PRO - 857.....	98
BOND EPO - 859 .....	98
BOND - 861 .....	98
CRACK POL WT - 815 .....	99
PACKER - 70 - 120 .....	99
CRACK EPO - 816 .....	99
EPO GUN - 1100 .....	99
PU GUN - 1000 .....	99

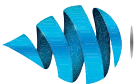

# WATER INSULATION PRODUCTS SCHEDULE

<div></div> <div>Teknik Yapı Kimyasalları</div>																																																																																																																																																																																																																																																																																																																																																																																																																																																																																																																																																																																																																																																																																																																																																																																																																																																																																																																																																																																																																																																																																																																																																																																																																																																																																																																																																																																																																																																																																																																																																																																																
BASIS INSULATION	Basis Six																																																																																																																																																																																																																																																																																																																																																																																																																																																																																																																																																																																																																																																																																																																																																																																																																																																																																																																																																																																																																																																																																																																																																																																																																																																																																																																																																																																																																																																																																																																																																																																															



## 1- POOL CERAMIC APPLICATION

CERA-CEM -908	(Syf - 66)
CERA-CEM PLUS - 909	(Syf - 66)
CERA-CEM FLEX - 910	(Syf - 67)
CERA-CEM FLEX 2K - 912	(Syf - 68)
CERA EPO - 915	(Syf - 68)
CERA FUGA - 913	(Syf - 69)
CERA FUGA FLEX - 914	(Syf - 69)

## 2- WATERPROOF POOL INSULATION

AQUATEX - 2700	(Syf - 82)
BITUMEPOL - 812	(Syf - 42)
D-LASTIC - 424	(Syf - 32)
D-LASTIC PLUS - 425	(Syf - 33)
D-LASTIC SUPER - 430	(Syf - 33)
D-LASTIC SUPER X - 427	(Syf - 34)

## 3 - EPOXY FLOOR APPLICATION

EPO PR - 850	(Syf - 60)
EPO PAINT - 852	(Syf - 62)
EPO SELF - 854	(Syf - 61)

## 4 - GARDEN TERRACE WATERPROOFING

BITUMEPOL - 812	(Syf - 42)
BITUMEN PLUS-300	(Syf - 24)

## 5- EXTERIOR WALL WATERPROOFING

D-NANO - 615	(Syf - 94)
AQUAWALL 606	(Syf - 90)

## 6 - HEAT INSULATION SYSTEM

D-THERM	(Syf - 76)
---------	------------

## 7 - WATER INSULATION

AQUATEX - 2700	(Syf - 82)
AQUAPOL - 810	(Syf - 41)
D-LASTIC - 424	(Syf - 32)
D-LASTIC PLUS - 425	(Syf - 33)

## 8- CERAMIC APPLICATION

CERA-CEM -908	(Syf - 66)
CERA-CEM PLUS - 909	(Syf - 66)
CERA-CEM FLEX - 910	(Syf - 67)
CERA-CEM FLEX W-911	(Syf - 67)
CERA-CEM FLEX 2K - 912	(Syf - 68)
CERA EPO - 915	(Syf - 68)
CERA FUGA - 913	(Syf - 69)
CERA FUGA FLEX - 914	(Syf - 69)

## 9 - ROOF INSULATION

COOL ROOF ALM - 608	(Syf - 39)
---------------------	------------

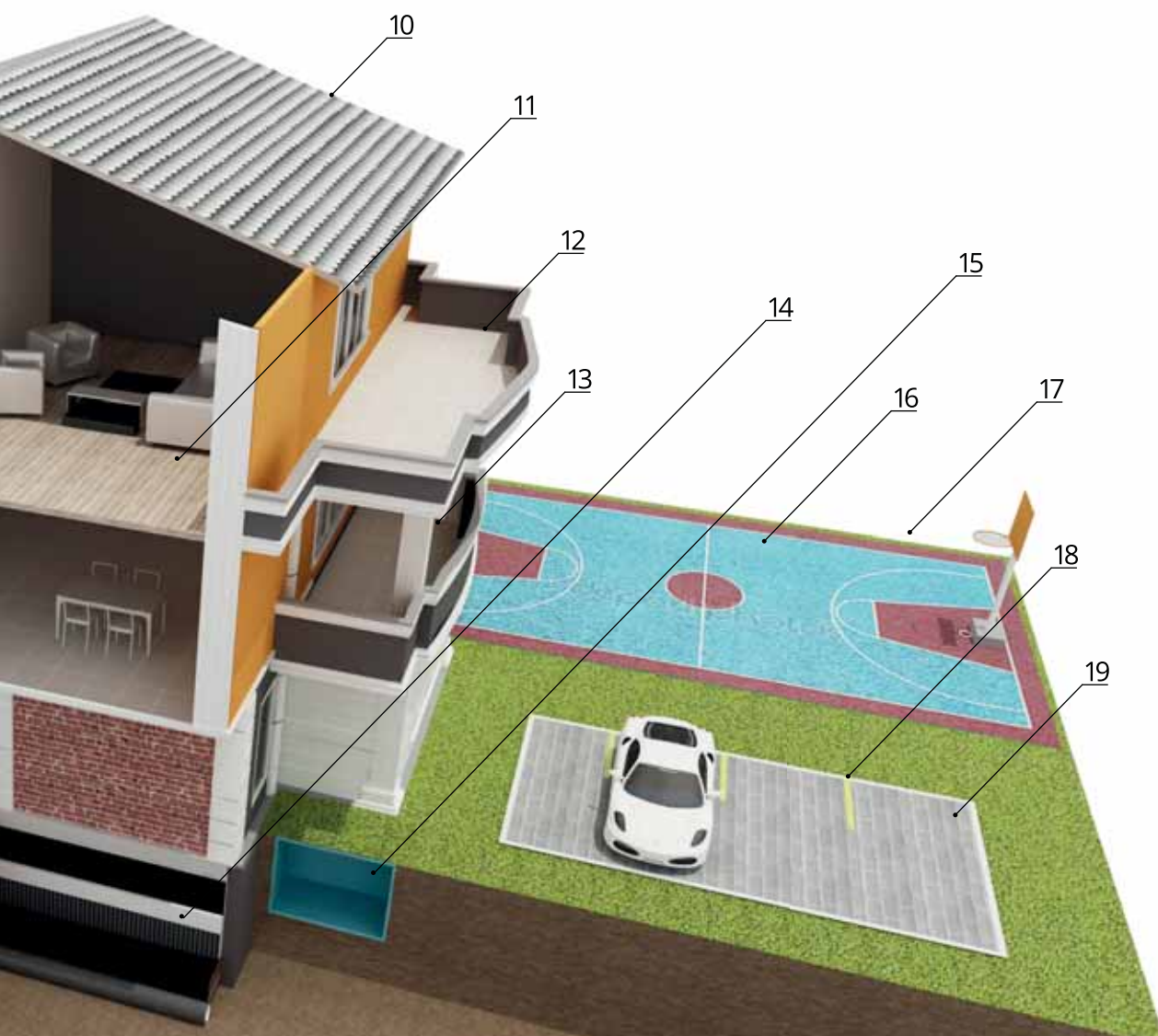

#### 10 - ROOF INSULATION

- COOL ROOF - 607 (Syf - 39)
- AQUAFLEX UV 202 (Syf - 38)

#### 11 - SELF-EXTENSION

- D-LEVEL - 750 (Syf - 50)

#### 12 - WATERPROOF INSULATION ON CERAMIC

- AQUAPOL TRANS-814 (Syf - 43)
- AQUAPOL HIBRIT TRANS-1002 (Syf - 44)
- AQUAPOL UV-811 (Syf - 41)
- PURSIS-833 (Syf - 44)

#### 13 - BALCONY TERRACE WATERPROOFING

- AQUAPOL - 810 (Syf - 41)
- D-LASTIC - 424 (Syf - 32)
- D-LASTIC PLUS - 425 (Syf - 33)
- D-LASTIC SUPER - 430 (Syf - 33)
- D-LASTIC SUPER X - 427 (Syf - 34)

#### 14 - BASIC SHEAR WATERPROOFING

- BITUMEN PLUS-300 (Syf - 24)
- BITUMEPOL - 812 (Syf - 42)
- BITUMEN-302 (Syf - 25)
- BITUMEN-303 (Syf - 26)
- D-LASTIC PLUS - 425 (Syf - 33)
- D-LASTIC SUPER - 430 (Syf - 33)

#### 15 - DRINKING WATER WAREHOUSE INSULATION

- AQUAPOL 2K - 813 (Syf - 42)
- CRYSTA 404 (Syf - 30)
- CRYSTA PLUS 2K 405 (Syf - 31)

#### 16 - FLOOR PAINTING FOR SPORT FLOOR

- COURT PAINT-613 (Syf - 91)

#### 17 - FLOOR HARDENER APPLICATION

- HARD-C - 700 (Syf - 54)

#### 18 - ROAD PAINT

- ROAD PAINT-612 (Syf - 93)

#### 19 - FLOOR PAINT

- FLOOR PAINT - 611 (Syf - 92)

## BASIC SHADE INSULATION

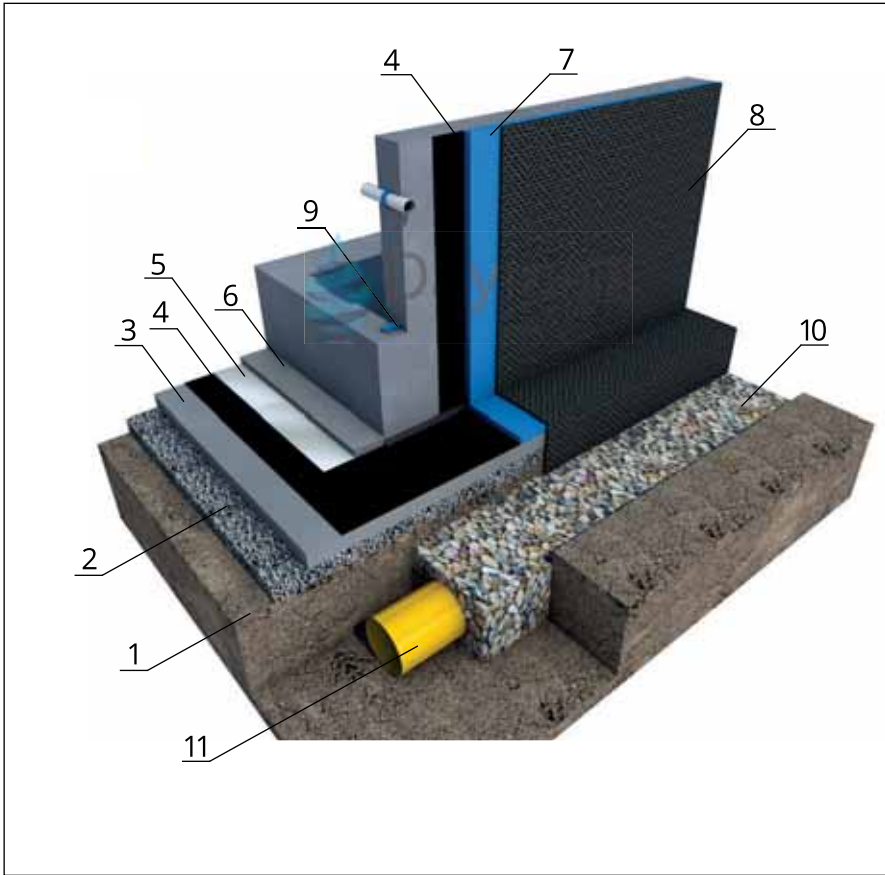

- 1- SAND
- 2- FILLER
- 3- LEAN CONCRETE
- 4- BITUMEN PLUS-300 (Syf - 24)
- 5- NYLON (PE-FOLYO)
- 6- PROTECTIVE CONCRETE
- 7- INSULATING BOARD
- 8- DRANIAGE PLATE
- 9- AQUABAND AC 5 x 20 - 10 x 20 (Syf - 83)
- 10- DRANIAGE FILLER
- 11- DRANIAGE PIPE

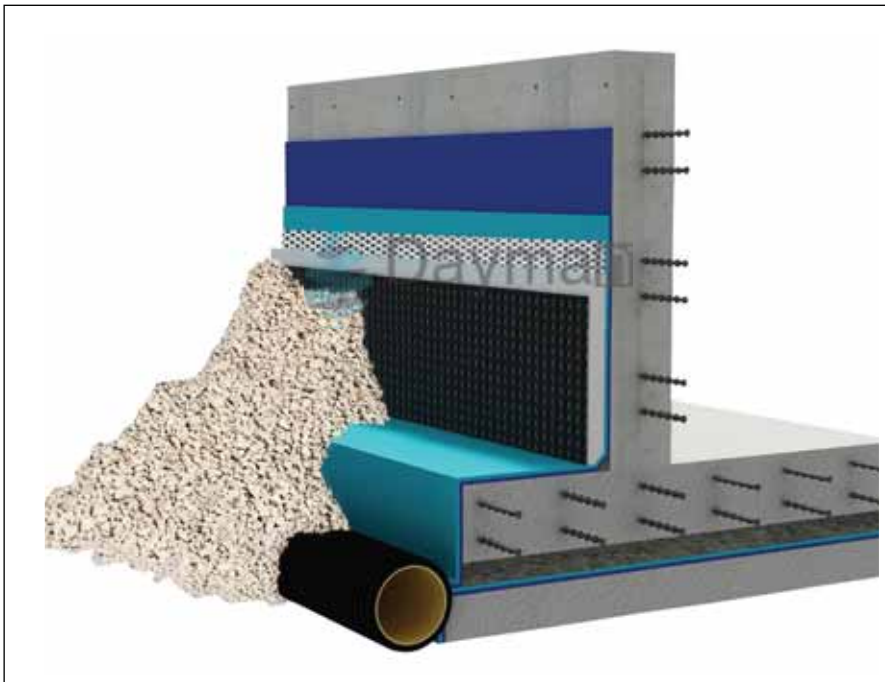

- 4- DAYMAN
- D-LASTIC - 424 (Syf - 32)
- D-LASTIC PLUS - 425 (Syf - 33)
- D-LASTIC SUPER - 430 (Syf - 33)
- D-LASTIC SUPER X - 427 (Syf - 34)
- AQUAPOL - 810 (Syf - 41)
- BITUMEPOL - 812 (Syf - 42)



## POOL AND WET AREAS INSULATION

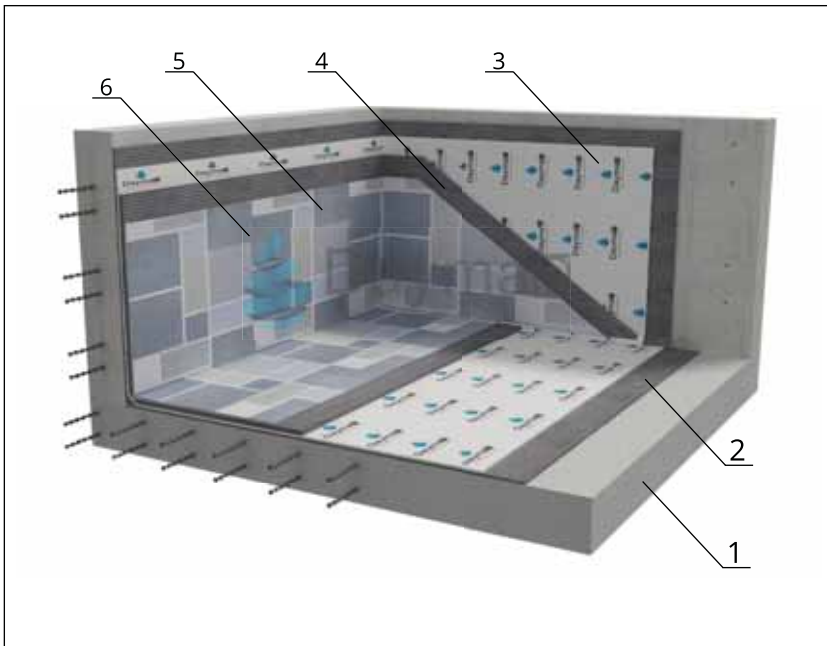

- 1- CONCRATE
- 2- D-LASTIC SUPER - 430 (Syf - 33)  
D-LASTIC SUPER X - 427 (Syf - 34)  
CERA-CEM FLEX 2K - 912 (Syf - 66)
- 3- AQUATEX - 2700 (Syf - 80)
- 4- CERA-CEM - 908 (Syf - 64)  
CERA-CEM PLUS - 909 (Syf - 64)  
CERA-CEM FLEX - 910 (Syf - 65) C  
ERA-CEM FLEX 2K - 912 (Syf - 65) C  
ERA EPO - 915 (Syf - 66)
- 5- CERA FUGA - 913 (Syf-67) C  
ERA FUGA FLEX - 914 (Syf-67)  
CERA EPO - 915 (Syf - 66)
- 6- CERAMIC

## WET AREA INSULATION

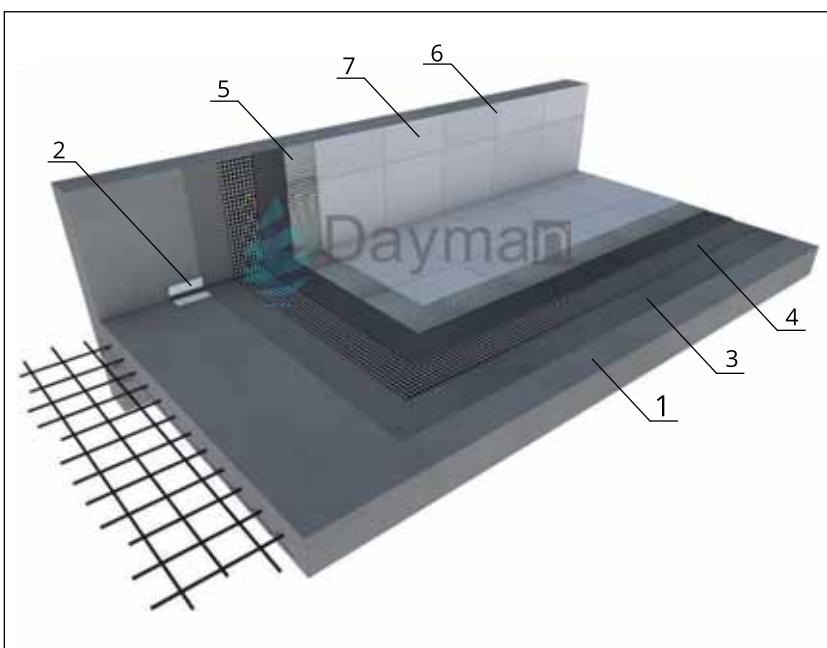

- 1- CONCRATE
- 2- D-LASTIC - 424 (Syf - 32)  
D-LASTIC PLUS - 425 (Syf - 33)  
D-LASTIC SUPER - 430 (Syf - 33)  
D-LASTIC SUPER X - 427 (Syf - 34)
- 3- FILE
- 4- CERA-CEM - 908 (Syf - 64)  
CERA-CEM PLUS - 909 (Syf - 64)  
CERA-CEM FLEX - 910 (Syf - 65)  
CERA-CEM FLEX 2K - 912 (Syf - 65)  
CERA EPO - 915 (Syf - 66)
- 5- CERA FUGA - 913 (Syf-67)  
CERA FUGA FLEX - 914 (Syf-67)  
CERA EPO - 915 (Syf - 66)
- 6- CERAMIC

## GARDEN TERRACE INSULATION

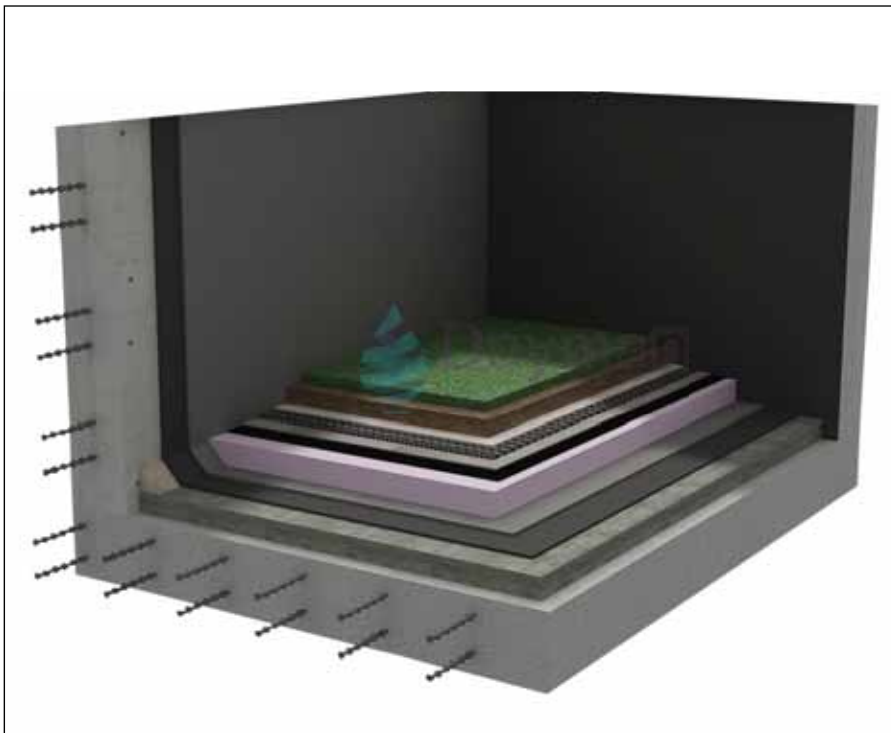
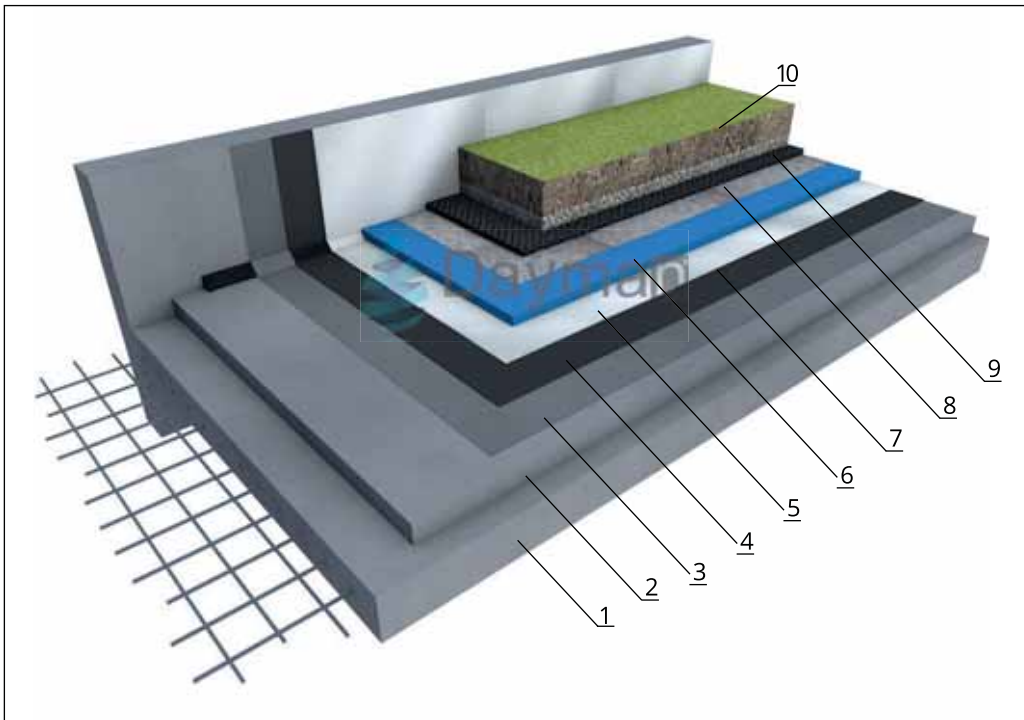

- 1- CONCRATE
- 2- LEVELING CONCRATE
- 3- AQUAPOL PR - 800 (Syf - 40)  
AQUAPOL PR WT 2K 801 (Syf - 40)  
BITUMEN PR - 304 (Syf - 24)
- 4- BITUMEPOL - 812 (Syf - 42)  
AQUAPOL - 810 (Syf - 41)  
AQUA HIBRIT - 1001 (Syf - 43)  
PURSIS - 833 (Syf - 44)
- 5- NYLON (PE FOLYO)
- 6- INSULATION BOARD
- 7- GEOTEXTILE FELT
- 8- DRAINAGE BOARD
- 9- PEBLE
- 10- SAND

## SWIMMING POOL INSULATION

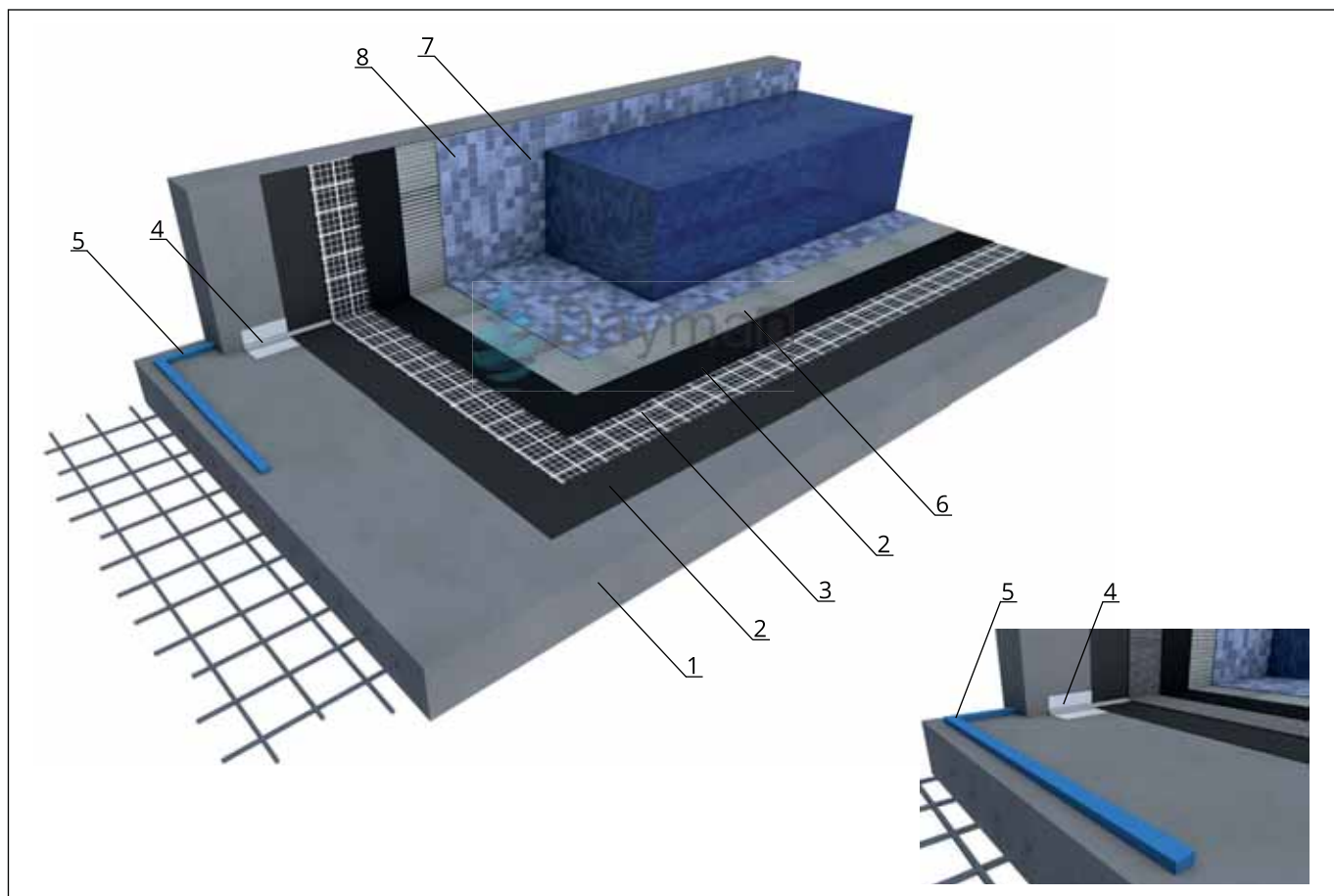

1- CONCRATE

2- D-LASTIC - 424 (Syf - 32)

D-LASTIC PLUS - 425 (Syf - 33)

D-LASTIC SUPER - 430 (Syf - 33)

D-LASTIC SUPER X - 427 (Syf - 34)

3- D-TEX 45 (Syf - 80)

4- D-BAND 120-120AR (Syf - 82)

D-BAND ST 100-200 (Syf - 82)

TEXBAND - 2910 (Syf - 81)

5- AQUABAND AC 5x20 - 10x20 (Syf - 83)

6- CERA-CEM - 908 (Syf - 64)

CERA-CEM PLUS - 909 (Syf - 64)

CERA-CEM FLEX - 910 (Syf - 65)

CERA-CEM FLEX 2K - 912 (Syf - 65)

CERA EPO - 915 (Syf - 66)

7- CERA FUGA - 913 (Syf-67)

CERA FUGA FLEX - 914 (Syf-67)

CERA EPO - 915 (Syf - 66)

8- POOL CERAMIC

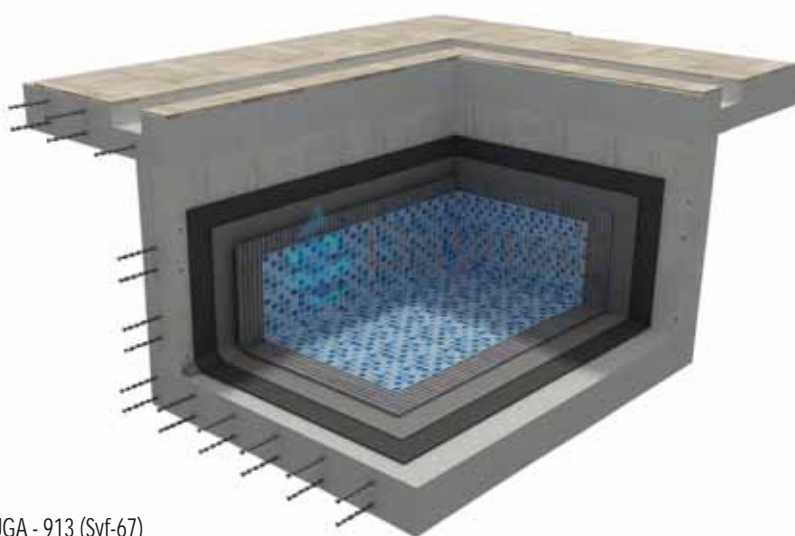

## UV PROTECTIVE WALKING TERRACE

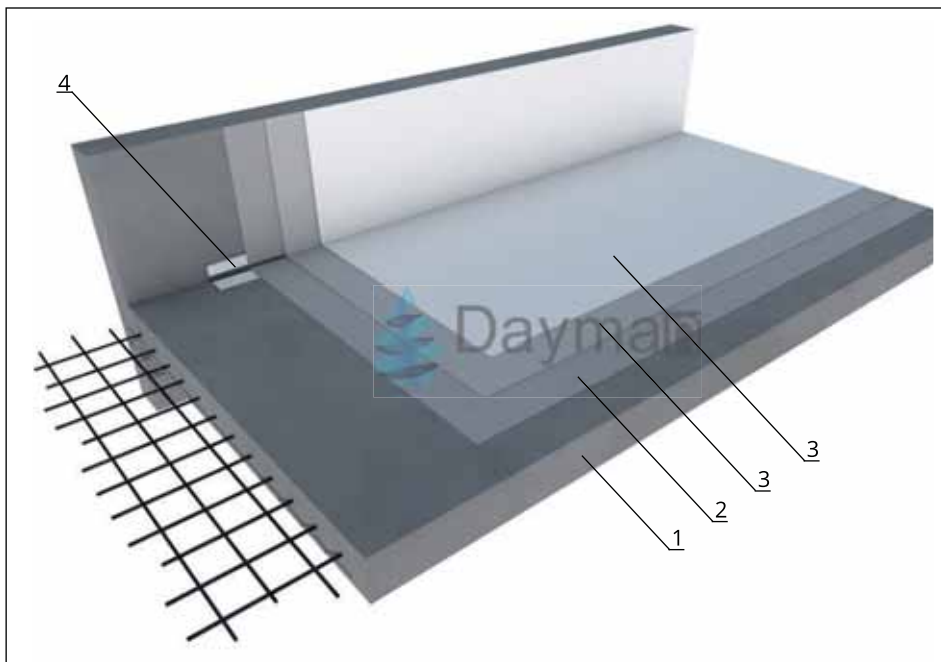

- 1- CONCRATE
- 2- AQUAPOL PR - 800 (Syf - 40)  
AQUAPOL PR WT 2K 801 (Syf - 40)
- 3- AQUAPOL UV-811 (Syf - 41)
- 4- D-BAND 120-120AR (Syf - 82)  
D-BAND ST 100-200 (Syf - 82)  
TEXBAND - 2910 (Syf - 81)

## UV PROTECTIVE NON WALK TERRACE INSULATION

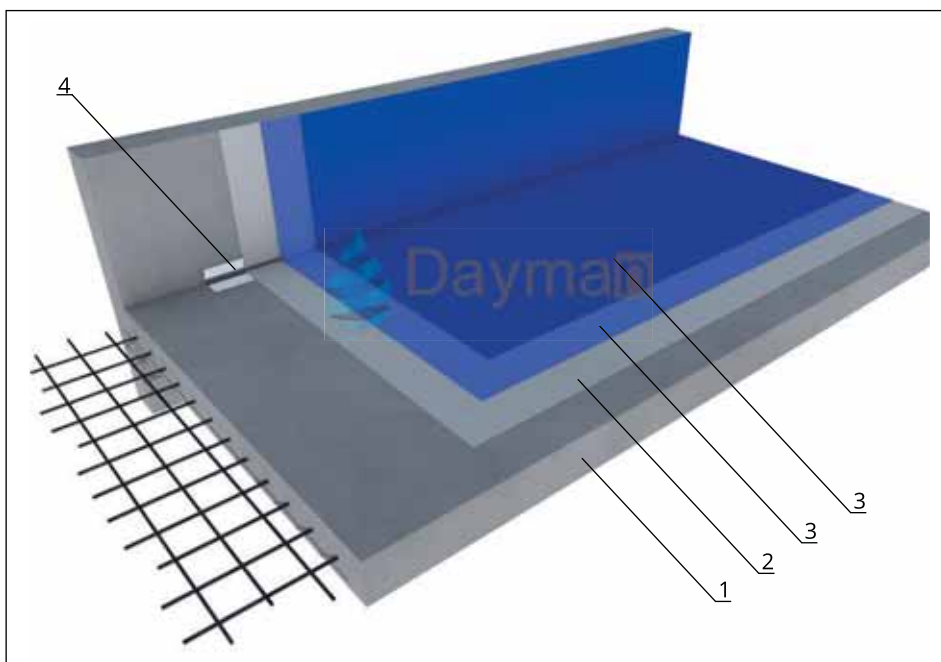

- 1- CONCRATE
- 2- AQUAPOL PR - 800 (Syf - 40)  
AQUAPOL PR WT 2K 801 (Syf - 40)  
AQUAFLEX -202 (Syf - 38)  
COOL ROOF 607 (Syf - 39)
- 3- AQUAPOL UV - 200 (Syf - 38)  
AQUAFLEX UV 202 (Syf - 38)  
COOL ROOF 607 (Syf - 39)
- 4- D-BAND 120-120AR (Syf - 82)  
D-B AND ST 100-200 (Syf - 82)  
TEXBAND - 2910 (Syf - 81)



## WALKING TERRACE INSULATION

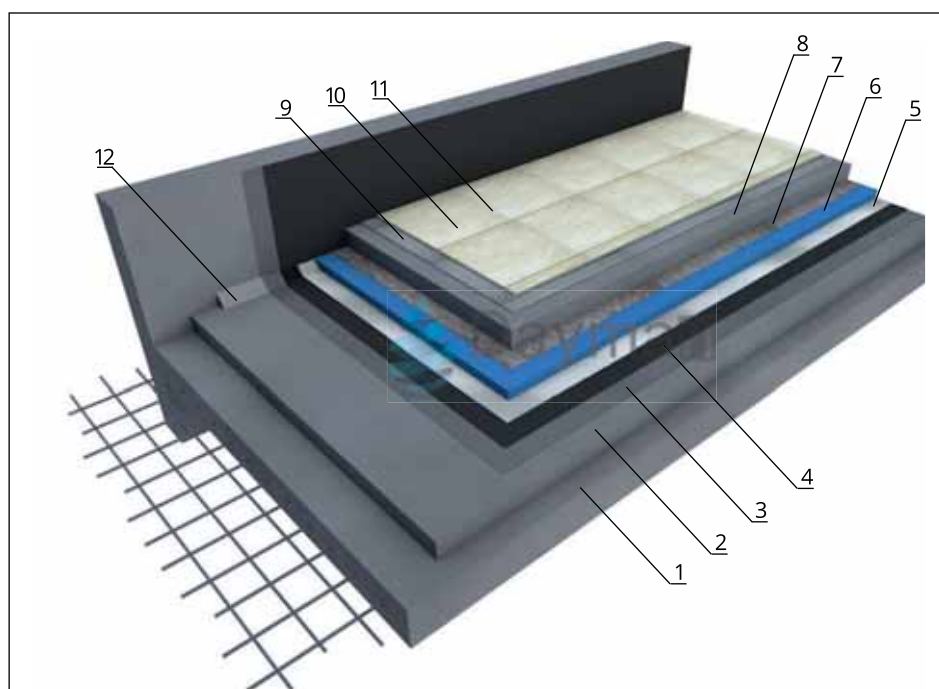

- 1- CONCRATE
- 2- LEVELING CONCRATE
- 3- AQUAPOL PR - 800 (Syf - 40)  
AQUAPOL PR WT 2K 801 (Syf - 40)
- 4- BITUMEPOL - 812 (Syf - 42)  
AQUAPOL - 810 (Syf - 41)  
D-LASTIC PLUS - 425 (Syf - 33)  
D-LASTIC SUPER - 430 (Syf - 33)  
D-LASTIC SUPER X - 427 (Syf - 34)

- 5- DEFOLYO (Nylon)
- 6- INSULATION BOARD
- 7- GEO TEXTILE FELT
- 8- LEVELING CONCRATE

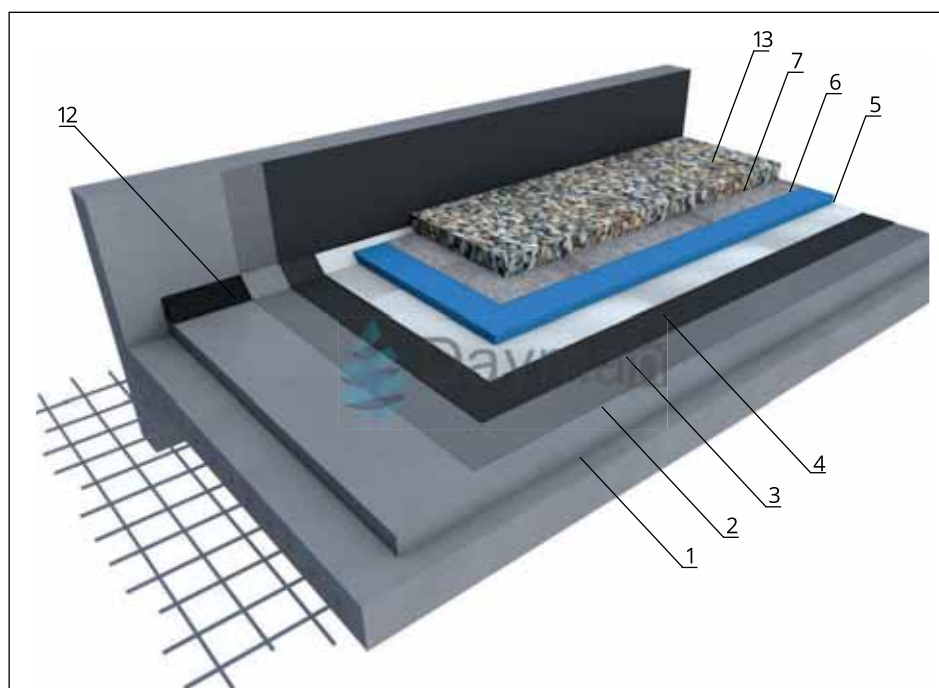

- 9- CERA-CEM -908 (Syf - 64)  
CERA-CEM PLUS - 909 (Syf - 64)  
CERA-CEM FLEX - 910 (Syf - 65)  
CERA-CEM FLEX 2K - 912 (Syf - 65)  
CERA EPO - 915 (Syf - 66)
- 10- CERA FUGA - 913 (Syf-67)  
CERA FUGA FLEX - 914 (Syf-67)  
CERA EPO - 915 (Syf - 66)
- 11- CERAMIC
- 12- REPAI RPLUS

## NEGATIVE WATER INSULATION (Cellar-Elevator Cell)

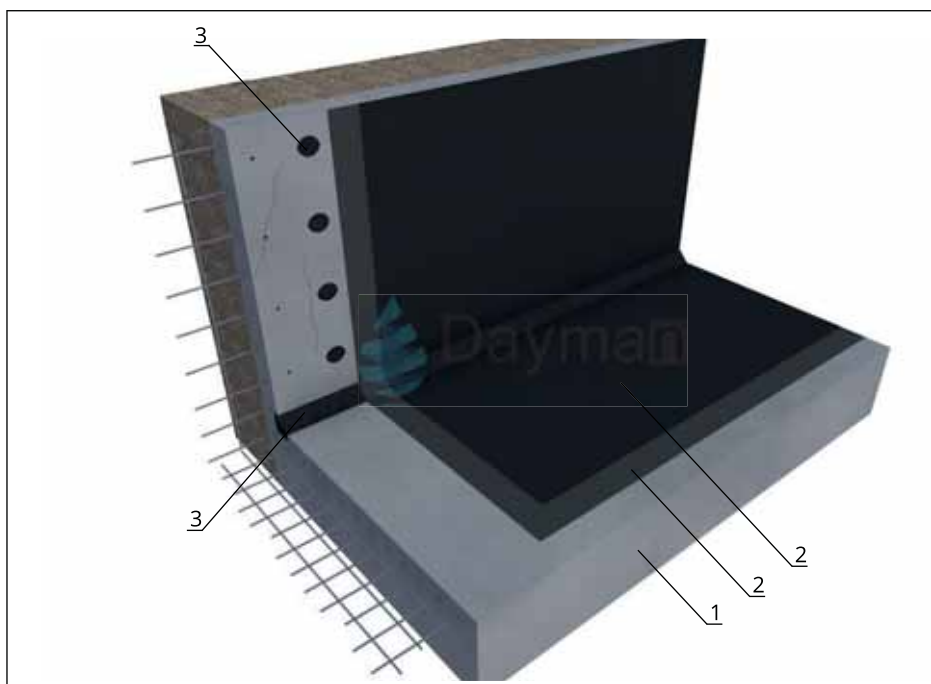

- 1- COCRATE
- 2- CYRISTA 404 (Syf - 30)  
CYRISTA PLUS 2K 405 (Syf - 31)
- 3- REPAIR PLUS



## DILATATION APPLICATION

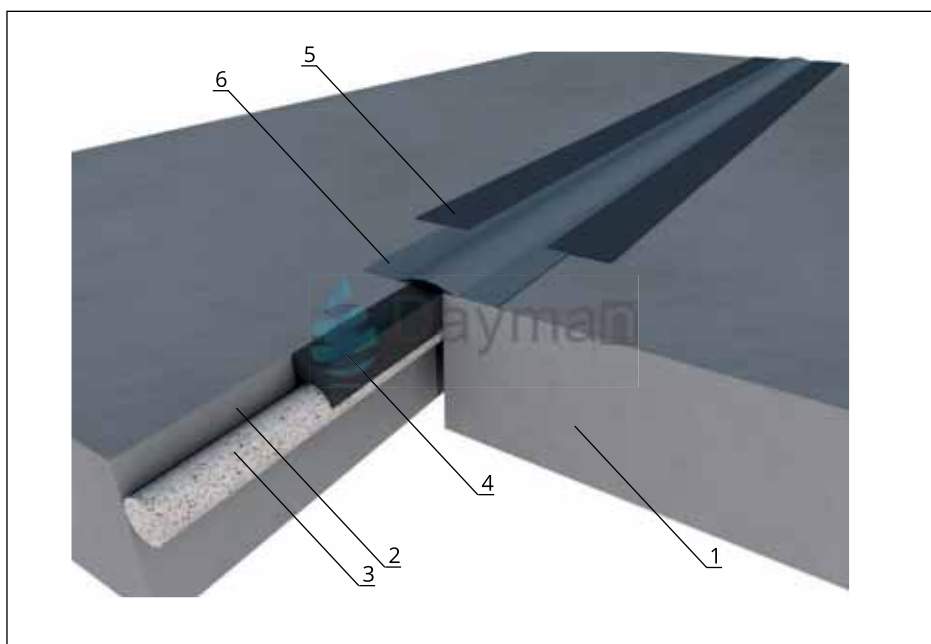

- 1- COCRATE
- 2- PUSEAL PR150 (Syf - 84)
- 3- P.E. FITİL
- 4- PU SEAL (Syf - 84)  
PU SEAL 2K (Syf - 84)
- 5- BOND EPO PRO 857 (Syf - 96)
- 6- AQUA BAND 25-30-40 (Syf - 83)

## HIDDEN GUTTER INSULATION



- 1- CONCRATE
- 2- REPAIR PLUS - 905 (Syf - 49)
- 3- AQUAPOL PR - 800 (Syf - 40)  
AQUAPOL PR WT - 801 (Syf - 40)  
AQUAFLEX 202 (Syf - 38)  
COOL ROOF 607 (Syf - 39)
- 4- AQUAPOL UV - 200 (Syf - 38)  
AQUAFLEX UV 202 (Syf - 38)  
COOL ROOF 607 (Syf - 39)

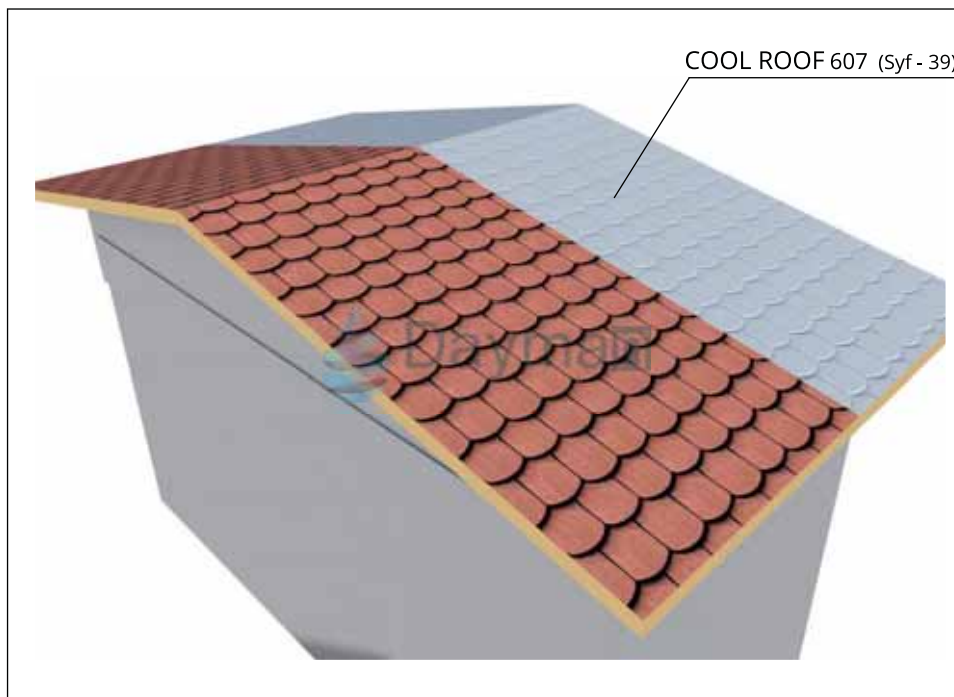

## GROUT IMPLEMENTATION

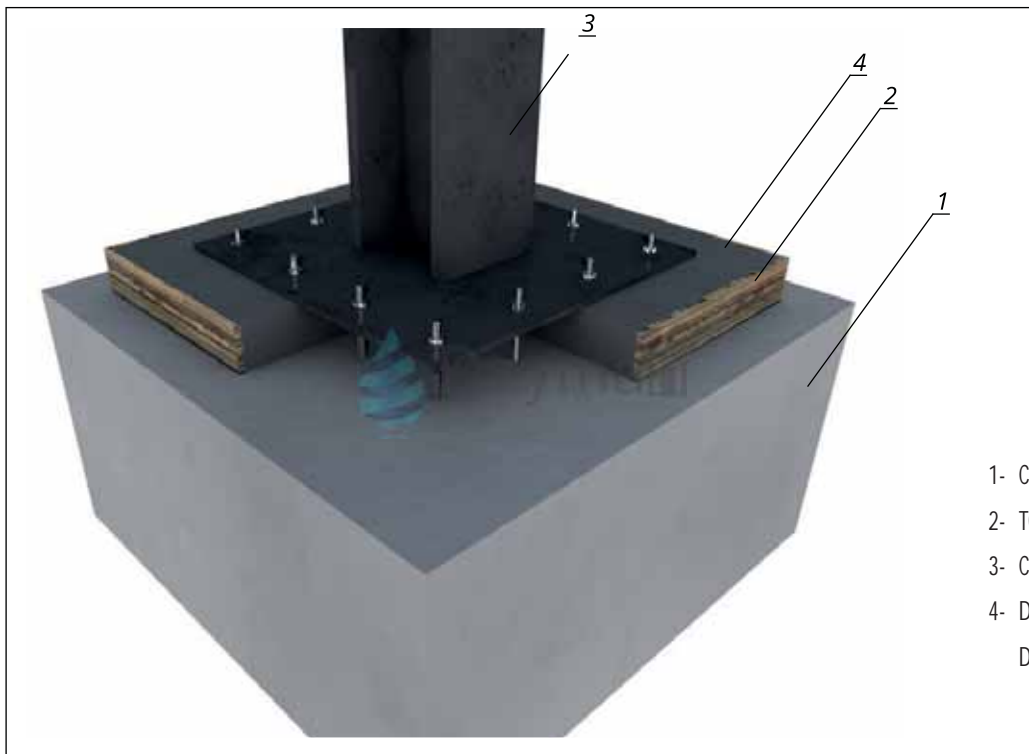

- 1- COCRATE
- 2- TOOL
- 3- COLUMN
- 4- D-GROUT - 901 (Syf - 51)  
D-GROUT SPEED -902 (Syf - 51)

## REPAIRMENT

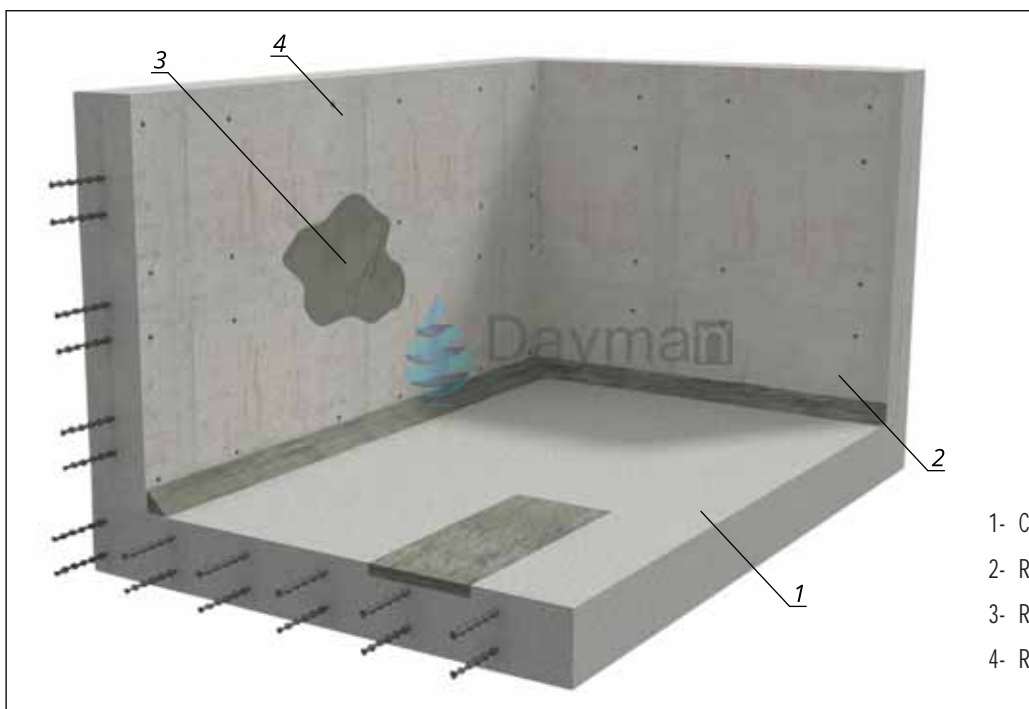

- 1- CONCRATE
- 2- REPAIR PLUS 905 (Syf - 49)
- 3- REPAIR PLUS 905 (Syf - 49)
- 4- REPAIR PLUS 905 (Syf - 49)

## PU INJECTION IMPELATION



## WATER SEALANT IMPELATION

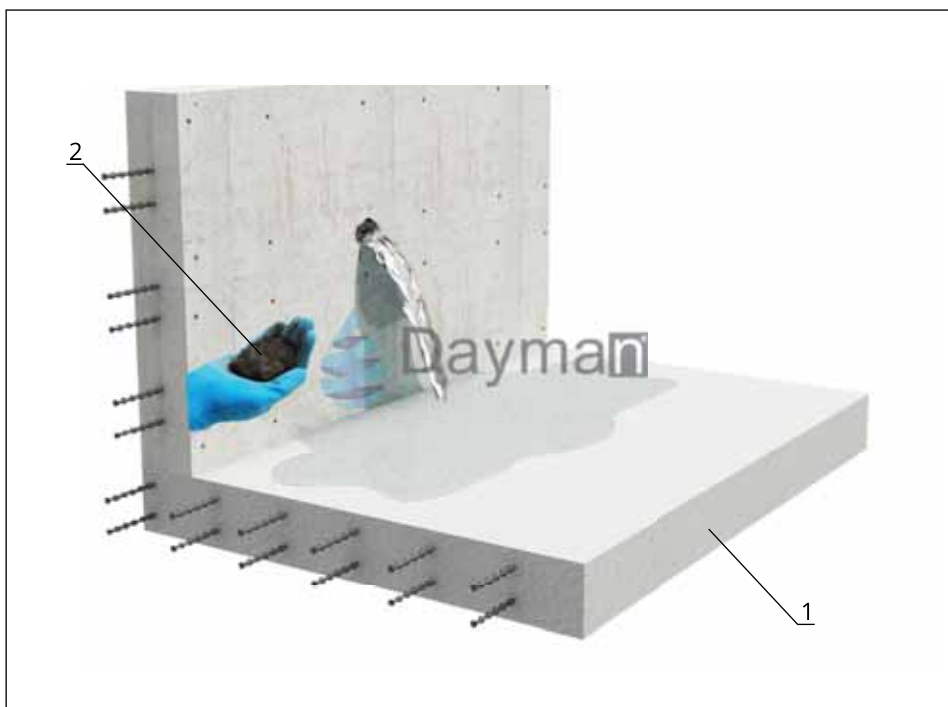







## BITUMEN BASED PRODUCTS

## BITUMEN PLUS - 300

POLYMER MODIFIED BITUMEN RUBBER CONTAINED, BINARY COMPONENT  
WATER INSULATION PRODUCT TS EN 15814 W2A



### DESCRIPTION:

- Polymer modified bitumen contained, binary component, elastic, high viscosity, thick water insulation covers.
- TS EN 15814 W2A Class Conformity.
- DIN 18191 Class Conformity

### USAGE AREAS :

- Basic and shades walls,
- Water areas, retaining wall,
- in the protection of the building and the building elements which has permanent or temporary water pressure or insulation
- Insulation and to stick drainage and panel which using instead of drainage.

	A	B	TOTAL
PACKING	22.00 kg	8.00 kg	30.00 kg
CONSUME	3,00 – 5,00 Kg/m <sup>2</sup>	BARKOD	8680746481169



### ADVANTAGES

- Easy preparation and implementation.
- Not includes solvent, environment friend.
- Provides a complete covers without an adding.
- Could be used in vertical and horizontal floors.
- Could stick strongly in the area which used.
- Crack repairmen is a plus.





## BITUMEN PLUS - 302

POLYMER MODIFIED BITUMEN RUBBER CONTAINED, BINARY COMPONENT WATER INSULATION PRODUCT TS EN 15814 W2A  
TS EN 15814 W1



### DETERMINATION:

- Polymer modified bitumen contained, binary component, elastic, high viscosity, thick water insulation covers.
- TS EN 15814 W2A Class conformity.
- DIN 18191 Class Conformity.

### USAGE AREAS :

- Basic and shades walls,
- Wet areas, retaining wall,
- in the protection of the building and the building elements which has permanent or temporary water pressure or insulation
- Insulation and to stick drainage and panel which using instead of drainage.

PACK	A	B	TOTAL
	22.00 kg	8.00 kg	30.00 kg
CONSUME	3,00 - 5,00 kr/m <sup>2</sup>		 8680746480018



### ADVANTAGES

- Easy preparation and implementation.
- Not includes solvent, environment friend.
- Provides a complete covers without an adding.
- Could be used in vertical and horizontal floors.
- Could stick strongly in the are which used.
- Crack repairmen is a plus.



## BITUMEN - 303

POLYMER MODIFIED BITUMEN RUBBER CONTAINED, BINARY COMPONENT  
WATER INSULATION PRODUCT TS EN 15814 W2A



PACK	20.00 kg	CONSUME	3,00 – 6,00 Kg/m <sup>2</sup>
BARKOD	 8680746480032		

### DETERMINATION:

Ploymer modified bitumen contained, binary component, elastic, high viscosity, thick water insulation covers.



### USAGE AREAS :

- Basic and shades walls,
- Wat areas, retaining wall,
- in the protection of the building and the building elements which has permanent or temporary water pressure or insulation
- Insulation and to stick drainage and panel which using instead of drainage.

### ADVANTAGES

- Easy preparation and implementation.
- Not includes solvent, environment friend.
- Provides a complete covers without an adding.
- Could be used in vertical and horizontal floors.
- Could stick strongly in the are which used.
- Crak repairmen is a plus.



## BITUMEN PR - 304

POLYMER MODIFIED BITUMEN RUBBER CONTAINED, BINARY COMPONENT WATER INSULATION PRODUCT



PACK	17.00 Kg	CONSUME	3,00 - 6,00 Kg/m <sup>2</sup>
BARKOD	 8680746480049		

### DEFINITION:

- Polymer modified bitumen rubber contained, binary component water insulation products .

### USAGE AREAS :

- Basic and shades walls,
- Wat areas, retaining wall,
- in the protection of the building and the building elements which has permanent or temporary water pressure or insulation
- Insulation and to stick draniage and panel which using instead of drainage.



### ADVANTAGES:

- Easy preparation and implementation.
- Not includes solvent, environment friend.
- Provides a complete covers without an adding.
- Could be used in vertical and horizontal floors.
- Could stick strongly in the are which used.
- Crak repairmen is a plus.









## MINERAL BASED WATERPROOFING PRODUCTS



PACK	25.00 kg	CONSUME	2,00 – 4,00 Kg/m <sup>2</sup>
BARKOD	 8680746480056		



## CRYSTA - 404

CEMENTCONTAINED,SINGLE CRYSTALLIZED COMPONENT WATERPROOFINGPRODUCT

### DETERMINATION:

- Cement contains, polymer emulsion consolidated, containing special chemicals, single component crystallized water insulation mortar.
- Proper to use in the drinkable water stock for insulation.
- Resistance dayanıklıdır.
- When the Crysta-404 goes in reaction with the free calcium particles, creates crystallite to fill the capillary break in the concrete.
- Available use across positive and negative water pressure.

### USAGE AREAS:

- Water insulation of the concrete surface,
- Water insulation of the elevator pit,
- Water insulation of the vertical and horizontal surfaces,
- Water insulation across the negative and positive part,
- Water stock,
- Reinforced concrete pipe,
- To protect the concrete against water,salt,carbonate
- Suitable usage for the builds that located under or up of the ground.

### ADVANTAGES:

- Easy preparation,
- Applicable by brush and blasting equipment,
- Working time is extended,
- It provides a permanent waterproofing with the crystals it creates,
- It forms a waterproofing layer that is free of joints, seamless, permanent, moisture and waterproof,
- It is resistant to chemical and salt solutions in the ground,
- Applicable to moist surface,
- Provides a high level of resistance to the freeze-thaw cycle.
- Suitable use for drinkable water ,
- Fills 0,4 mm wide cracks by forming crystals.
- It has a constantly active structure.





	A	B	TOTAL
	25.00 kg	3.00 kg	28.00 kg
	2,00 – 4,00 Kg/m <sup>2</sup>	BARKOD	 8680746480063



## CRYSTA PLUS 2K - 405

CEMENT ACRYLIC BASED TWO COMPOUND  
CRYSTALLIZATION WATERPROOFING PRODUCT

### DETERMINATION:

- Cement contains, polymer emulsion consolidated, containing special chemicals, single component crystallized water insulation mortar.
- Proper to use in the drinkable water stock for insulation.
- Resistance dayanıklıdır.
- When the Crysta-404 goes in reaction with the free calcium particles, creates crystallite to fill the capillary break in the concrete.
- Available use across positive and negative water pressure.

### USAGE AREAS:

- Water insulation of the concrete surface,
- Water insulation of the elevator pit,
- Water insulation of the vertical and horizontal surfaces,
- Water insulation across the negative and positive part,
- Water stock,
- Reinforced concrete pipe,
- To protect the concrete against water,salt,carbonate
- Suitable usage for the builds that located under or up of the ground.



### ADVANTAGES:

- Easy preparation,
- Applicable by brush and blasting equipment,
- Working time is extended,
- It provides a permanent waterproofing with the crystals it creates,
- It forms a waterproofing layer that is free of joints, seamless, permanent, moisture and waterproof,
- It is resistant to chemical and salt solutions in the ground,
- Applicable to moist surface,
- Provides a high level of resistance to the freeze-thaw cycle.
- Suitable use for drinkable water ,
- Fills 0,4 mm wide cracks by forming crystals.
- It has a constantly active structure.

## D-LASTIC - 424

CEMENT ACRYLIC BASED TWO COMPONENT FLEXIBLE WATERPROOFING PRODUCT



### DESCRIPT:

- Cement based, polymeremulsion consolidated, containing special chemicals, single component crytallized, waterproof mortar.
- Flexible.
- Very high adherence.
- Excellent adhesion to mineral-based surfaces.
- Resistant to temperature differences.

### USAGE AREAS:

- Waterproof of the; concrete, plaster, waterproofing of the mineral surfaces such as exposed concrete and screed.
- Balcony and terrace, bath, toilet, kitchen and under ceramic in the wet areas.
- Waterproofing of the vertical and horizontal surfaces.
- On the positive side in waterproofing.
- Waterproofing of structures on the ground,,
- In waterproofing of retaining walls and curtains,
- It is used for waterproofing the structures above and below the ground.

Applications should not be performed where water is observed from the negative side.

### ADVANTAGES:

- Easy preparation,
- Applicable by brush and blasting equipment,
- Working time is extended,
- It has high crack bridging feature.
- Creates a waterproofing layer without joints, seamless, permanent, moisture and waterproof.
- Resistant to chemical and salt solutions in the ground.
- Water vapor permeability.
- Provides a high level of strength in the freeze-thaw cycle.



PACKING	A	B	TOTAL
	20.00 kg	5.00 kg	25.00 kg
CONSUME	2,00 – 4,00 Kg/m <sup>2</sup>	BARKOD	8680746480070

## D-LASTIC SUPER UV - 426

CEMENT ACRYLIC BASED UV RESISTANT TWO COMPONENT FULLY ELASTIC WATERPROOFING PRODUCT



### DESCRIPTION:

- Private production for Dayman, Cement based, polymeremulsion consolidated, containing special chemicals, single component crytallized, waterproof mortar.
- Very high elasticity.

### USAGE AREAS:

- Water insulation for the areas which is exposed to concealed gutter, gutter and under the sun.
- Wirhout covering terrace insulation with less traffic
- Balcony and terrace, bath, toilet, kitchen and under ceramic in the wet areas
- Suitable usage for the builds that located under or up of the ground.

### ADVANTAGES:

- UV Protection.
- Easy and fast preperation .
- Applicable by brush and blasting equipment,
- High crack bridging feature.
- Creates a waterproofing layer without joints, seamless, permanent, moisture and waterproof.
- Resistant to chemical and salt solutions in the ground.
- Water vapor permeability.



PACKING	A	B	TOTAL
	20.00 kg	10.00 kg	30.00 kg
CONSUME	2,00 – 4,00 Kg/m <sup>2</sup>	BARKOD	8680746480117



## D-LASTIC PLUS - 425

CEMENT ACRYLIC BASED TWO COMPONENT FLEXIBLE WATERPROOFING PRODUCT



PACKING	A	B	TOTAL
	20.00 kg	10.00 kg	30.00 kg
CONSUME	2,00 – 4,00 Kg/m <sup>2</sup>	BARKOD	8680746480087

### DESCRIPTION:

- Private production for Dayman, Cement based, polymeremulsion consolidated, containing special chemicals, single component crystallized, waterproof mortar.
- Very high elasticity.
- High degree of crack bridging feature.
- Very high adherence.
- Excellent adhesion to mineral-based surfaces.
- Resistant to temperature differences.

### USAGE AREAS:

- Waterproof of the; concrete, plaster, waterproofing of the mineral surfaces such as exposed concrete and screed.
- Balcony and terrace, bath, toilet, kitchen and under ceramic in the wet areas.
- Waterproofing of the vertical and horizontal surfaces.
- On the positive side in waterproofing.
- Waterproofing of structures on the ground,
- In waterproofing of retaining walls and curtains,
- It is used for waterproofing the structures above and below the ground.

. Applications should not be performed where water is observed from the negative side.



### ADVANTAGES:

- Easy preparation,
- Applicable by brush and blasting equipment,
- Working time is extended,
- It has high crack bridging feature.
- Creates a waterproofing layer without joints, seamless, permanent, moisture and waterproof.
- Resistant to chemical and salt solutions in the ground.
- Water vapor permeability.
- Provides a high level of strength in the freeze-thaw cycle.

## D-LASTIC SUPER - 430

CEMENT ACRYLIC BASED TWO COMPONENT SUPER ELASTIC WATER INSULATION PRODUCT



PACKING	A	B	TOTAL
	20.00 kg	10.00 kg	30.00 kg
CONSUME	2,00 - 4,00 Kg/m <sup>2</sup>	BARKOD	8680746480094

### DESCRIPTION:

- Cement based, polymeremulsion consolidated, containing special chemicals, double component crystallized, waterproofing products.
- Very high elasticity.
- High degree of crack bridging feature.
- Very high adherence.
- Excellent adhesion to mineral-based surfaces.
- Resistant to temperature difference.

### USAGE AREAS:

- Waterproof of the; concrete, plaster, waterproofing of the mineral surfaces such as exposed concrete and screed.
- Balcony and terrace, bath, toilet, kitchen and under ceramic in the wet areas.
- Waterproofing of the vertical and horizontal surfaces.
- Waterproofing of structures on the ground,
- In waterproofing of retaining walls and curtains,
- It is used for waterproofing the structures above and below the ground.
- Applications should not be performed where water is observed from the negative side.

### ADVANTAGES:

- Extra elasticity.
- Easy and fast preparation,
- Applicable by brush and blasting equipment,
- Working time is extended,
- High crack bridging feature.
- Creates a waterproofing layer without joints, seamless, permanent, moisture and waterproof.
- Provides a high level of strength in the freeze-thaw cycle.





## D-LASTIC SUPER X - 427

CEMENT ACRYLIC BASED TWO COMPONENT SUPER ELASTIC QUICK WATERPROOFING PRODUCT

### DESCRIPTION:

- Cement based, polymer emulsion consolidated, containing special chemicals, double component, waterproofing products.
- Very high elasticity.
- High degree of crack bridging feature.
- Very high adherence.
- Excellent adhesion to mineral-based surfaces.
- Resistant to temperature difference.

### USAGE AREAS:

- Waterproof of the; concrete, plaster, waterproofing of the mineral surfaces such as exposed concrete and screed.
- Balcony and terrace, bath, toilet, kitchen and under ceramic in the wet areas.
- Waterproofing of the vertical and horizontal surfaces.
- Waterproofing of structures on the ground,
- In waterproofing of retaining walls and curtains
- It is used for waterproofing the structures above and below the ground.
- Applications should not be performed where water is observed from the negative side.

PACKING	5 + 5 = 10 Kg	CONSUME	2,00 – 3,00 Kg/m <sup>2</sup>
BARKOD	 8680746480100		



### ADVANTAGES:

- Has extraordinary elasticity
- Quick applicable
- Waiting time between coats is low.
- Easy and fast preparation,
- Can be applied with roller, brush, trowel and spraying equipment.
- Working time is extended,
- Very high crack bridging feature,
- Creates a waterproofing layer without joints, seamless, permanent, moisture and waterproof.
- Resistant to chemical and salt solutions in the ground.
- Water vapor permeability.
- Can be applied the moist surface.
- Provides a high level of strength in the freeze-thaw cycle.

## W-STOP - 440

### CEMENT-BASED SURFACE PRESS AREA WATER



PACKING	10.00 kg 5.00 kg	CONSUME	Variable
BARKOD			

#### DESCRIPTION:

It is a cement based, fast setting, mineral filler, water repellent special chemical additive containing one component water plug.

#### USAGE AREAS:

- Stopping the pressurized water,
- Operations of the underwater sttoping,
- Stopping active water leaks,
- Waterproofing of the cocrate surfaces,
- Waterproofing of the elevator well,
- Waterproofing of the horizontal and vertical surfaces,
- Waterproofing from negative and pozitive parts.
- In water stocks,
- Reinforcement concarte.



#### ADVANTAGES:

- When it comes into contact with water, it enters the reaction and hardens in 30-60 seconds to cut off the flow of water.
- Easy and fast preparation,

## W-STOP SPEED - 441

### CEMENT BASED IMMEDIATE PLUG WATER POWDER



PACKING	10.00 kg 5.00 kg	CONSUME	Variable
BARKOD			

#### DESCRIPTION

- Cement based, fast setting,containing special chemicals,waterproofing and one component water stopper tap.

#### USAGE AREAS:

- Stopping the pressurized water,
- Stopping the active leakage of the water on cracks,
- Stopping the water leakage,
- Waterproofing of the cocrate surfaces,
- Waterproofing of the elevator well,
- Waterproofing of the horizontal and vertical surfaces,
- Negatif ve pozitif taraftan su yalıtımında,
- In water stocks,
- Reinforcement concarte.

#### AVANTAJLARI:

When it comes into contact with water, it enters the reaction and hardens in 3-6 seconds to cut off the flow of water.

- Easy and fast preparatipon.







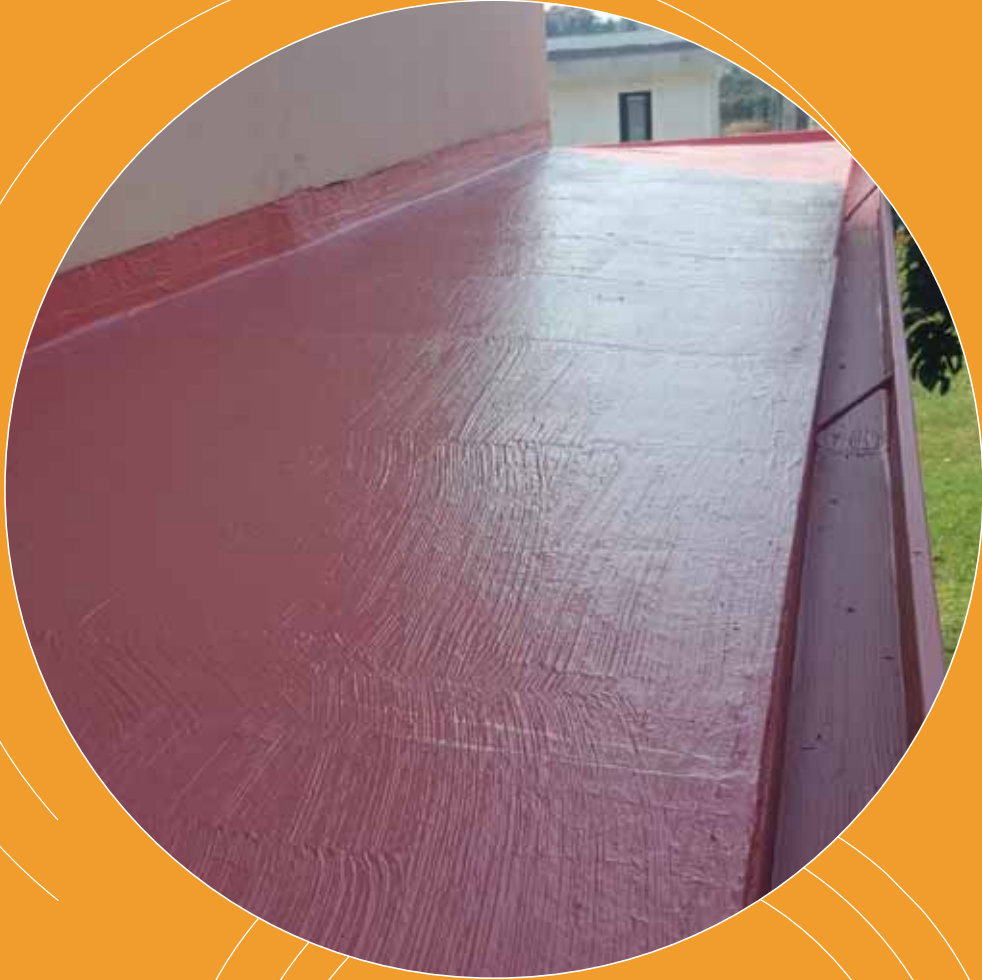

**RESIN BASED  
WATERPROOFING  
PRODUCTS**

## AQUAFLEX - 200

ACRYLIC RESIN BASED ELASTOMERIC WATERPROOFING PRODUCT



### DESCRIPTION:

Acrylic resin based elastomeric, one component, spreadable, waterproofing product.

### USAGE AREAS::

- Bath, toilet and ve wet areas,
- Under ceremicks as waterproofing material,
- Concrate, in the screed plaster surfaces,
- On cement board coated surfaces,
- On bitumen surfaces (old surface is must),

### ADVANTAGES:

- It can be covered by the cermamics.
- Very high elacticty.
- .High degree of crack bridging feature.
- Very high adherence.
- Easy and fast implementation.
- Can be applied with brush and spraying equipment.
- Due to eleatic typify has high resistant to temperature differenc-es,
- %600 stretch.
- Creates a waterproofing layer without joints,seamless, permanent,moisture and waterproof,
- Has high penetration,

PACK	20.00 kg 5.00 kg	CONSUME	1,50 – 2,50 Kg/m <sup>2</sup>
BARKOD	20.00 kg 8680746480148	5.00 kg 8680746481190	



## AQUAFLEX UV - 202

ACRYLIC RESIN BASED ELASTOMERIC UV RESISTANCE WATERPROOFING PRODUCT



### DESCRIPTION:

- UV resistance,elastomeric, acrylic resin based, one component, spreadable waterproofing product.

### USAGE AREAS::

- On untouched terraces,
- Hidden gutter and roof waterproofing,
- Repairment bitumen shingle,
- Steel sheet, galvanized steel sheet, pannel and coating waterproof,
- Surface of concrate, screed and plaster,
- On cement coated surfaces,
- On bitumen surfaces (old surface is must)

### ADVANTAGES:

- UV resistance.
- Very high elacticty.
- High degree of crack bridging feature.
- Very high adherence.
- Easy and fast implementation.
- Can be applied with brush and spraying equipment.
- Due to eleatic typify has high resistant to temperature differences,
- %1300 stretch.
- Creates a waterproofing layer without joints,seamless,
- permanent,moisture and waterproof,
- Has high penetration



PACK	20.00 kg 5.00 kg	CONSUME	1,50 – 2,50 Kg/m <sup>2</sup>
BARKOD	20.00 kg 8680746480155	5.00 kg 8680746481206	

## COOL ROOF - 607

ЖИДКОСТЬ БЕЛОГО ЦВЕТА ДЛЯ ГИДРОИЗОЛЯЦИИ И ТЕПЛОИЗОЛЯЦИИ КРОВЛИ



PACK	18.00 kg	CONSUME	1,50 – 2,50 Kg/m <sup>2</sup>
BARKOD	 8680746480926		

### DESCRIPTION:

- Increased solar reflectance, prevents heating of the applied surface by radiation, UV resistance, water based, acrylic emulsion based product.
- The product has been developed the result of long R & D efforts is that you can safely use it for the roof with its environmentally friendly formulation and high performance. Elastomeric, acrylic based, single component, water and heat insulation material.

### USAGE AREAS:

- Straight and inclined roof & terraces,
- Insufficient heating insulation, pannel and roofs,
- Metal sheet roof,
- Slate membrane and shingle applied surfaces,
- Untouched terraces,
- Steel sheet,galvanized steel sheet,panel and coasting waterproof,
- Surface of concrete, screed and plaster,
- On cement coated surfaces,

### ADVANTAGES:

- It can be covered by the cermamics.
- Very high elacticty.
- .High degree of crack bridging feature.
- Very high adherence.
- Easy and fast implementation.
- Can be applied with brush and spraying equipment.
- Due to eleatic typify has high resistant to temperature differences,
- %600 strech.
- Creates a waterproofing layer without joints,seamless, permanent,moisture and waterproof,
- Has high penetration,



## COOL ROOF ALM – 608

ROOF WATER AND HEAT INSULATION COVERING LIQUID ALUMINUM REINFORCED



PACK	18.00 kg	CONSUME	1,50 – 2,50 Kg/m <sup>2</sup>
BARKOD	 8680746480933		

### DESCRIPTION:

- Increased solar reflectance, prevents heating of the applied surface by radiation, UV resistance, water based, acrylic emulsion based product.
- The product has been developed the result of long R & D efforts is that you can safely use it for the roof with its environmentally friendly formulation and high performance. Elastomeric, acrylic based, single component, water and heat insulation material.

### USAGE AREAS:

- Straight and inclined roof & terraces,
- Insufficient heating insulation, pannel and roofs,
- Metal sheet roof,
- Slate membrane and shingle applied surfaces,
- Untouched terraces,
- Steel sheet,galvanized steel sheet,panel and coasting waterproof,
- Surface of concrete, screed and plaster,
- On cement coated surfaces,

### ADVANTAGES:

- Reflective feature supported by aluminum.
- Solar reflector keeps the applied surface cool.
- UV resistance.
- Very high elacticty
- High degree of crack bridging feature.
- Very high adherence.
- Easy and fast implementation.
- Can be applied with brush and spraying equipment.
- Due to eleatic typify has high resistant to temperature differences,
- %750 strech.
- Creates a waterproofing layer without joints,seamless,
- permanent,moisture and waterproof,





## AQUAPOL PR - 800

SINGLE COMPONENT POLYURETHANE BASED PRIMER



PACK	20.00 kg	CONSUME	0,100 - 0,300 Kg/m <sup>2</sup>
	4.00 kg		
BARKOD	20.00 kg	4.00 kg	
			
	8680746480162		8680746481213

### DESCRIPTION:

• Transparent, one component, polyurethane based lining product.

### ADVANTAGES:

- It adheres perfectly to all kinds of surfaces.
- Easy implementation,
- Provides excellent adhesion with absorbent surfaces.
- Dry in a short time.
- It perfectly covers the surface homogeneously.
- Quick apply
- After 4 hour , DAYMAN AQUA-POL810, DAYMAN AQUAPOL UV 811, AQUAPOL BITUMEN 812 veya AQUAPOL TRANS 814 can be applied surface.
- Can be used as primer for all polyurethane products,

### USAGE AREAS:

- Concrate
- Screed
- Plaster
- Wood
- Any absorbent surface can also be used as a polyurethane primer



## AQUAPOL PR WT - 801

SINGLE COMPONENT MOISTURE TOLERATED POLYURETHANE BASED PRIMER



PACK	A	B	TOTAL
	13.50 kg	4.50 kg	18 kg
CONSUME	0,100 - 0,300 Kg/m <sup>2</sup>	BARKOD	
			8680746480179

### DESCRIPTION:

• Transparent, one component, polyurethane based, moisture tolerated lining product.

### USAGE AREAS:

- Concrate
- Screed
- Plaster
- Wood
- Any absorbent surface can also be used as a polyurethane primer.

### ADVANTAGES:

- Can be used on the light humid surfaces,
- Easy implementation,
- Provides excellent adhesion with absorbent surfaces.
- Dry in a short time.
- It perfectly covers the surface homogeneously.
- Quick apply
- After 4 hour , DAYMAN AQUAPOL810, DAYMAN AQUAPOL UV 811, AQUAPOL BITUMEN 812 veya AQUAPOL TRANS 814 can be applied surface.

Can be used as primer for all polyurethane products,





## AQUAPOL - 810

### SINGLE COMPONENT POLYURETHANE BASED LIQUID WATERPROOFING PRODUCT



#### DESCRIPTION:

- Polyurethane based liquid, waterproof and for protection, economic elastic liquid waterproofing product.
- It forms an elastic and durable film by curing with humidity in the air.

#### ADVANTAGES:

- Low cost.
- Easy preparation (brush, roll or with airless spray).
- When applied, it forms a one-piece waterproofing layer that does not cause seams or leaks.
- Since it is a pure polyurethane, it can be in continuous contact with water.
- Heat resistance performance in wide temperature range, it is between -40 °C and + 80 °C.
- Permeability to water vapor is influential.
- Since it has a breathing property, it does not create moisture accumulation under the layer.
- Even if the waterproofing layer is damaged in any way, the damaged part can be easily repaired in a short time.
- Resistant to chemicals.

#### USAGE AREAS:

- Concrete surfaces,
- Plaster and cement panels,
- Internal and external application areas,
- Terraces,
- Top of the covered roofs,
- Wet areas,
- Baths,
- Under of the covered areas,
- Suitable usage also for the asphalt waterproofing layers.



PACK	25.00 kg 5.00 kg	CONSUME	1,20 - 1,50 Kg/m <sup>2</sup>
BARKOD	25.00 kg  8680746480186	5.00 kg  8680746481237	

## AQUAPOL UV - 811

### SINGLE COMPONENT UV RESISTANT POLYURETHANE BASED LIQUID WATERPROOFING PRODUCT



#### DESCRIPTION:

- UV resistant, single component, polyurethane based, low viscosity, waterproof and economical elastic liquid waterproofing product for protection.
- It forms an elastic and durable film by curing with humidity in the air.



#### USAGE AREAS:

- Terrace,
- Open top roofs,
- Wet areas,
- Baths,
- Under of the covered Areas,
- Suitable usage also for the asphalt waterproofing layers
- Autopark,
- Ditch,
- Concrete surfaces,
- Plaster and cement panels,
- Internal and external usage areas

#### ADVANTAGES:

- UV resistant.
- Easy preparation (brush, roll or with airless spray).
- When applied, it forms a one-piece waterproofing layer that does not cause seams or leaks.
- Since it is a pure polyurethane, it can be in continuous contact with water.
- Heat resistance performance in wide temperature range, it is between -40 °C and + 90 °C.
- Permeability to water vapor is influential.
- Since it has a breathing property, it does not create moisture accumulation under the layer.
- Even if the waterproofing layer is damaged in any way, the damaged part can be easily repaired in a short time.
- Resistant to chemicals.



PACK	25.00 kg 5.00 kg	CONSUME	1,40 - 2,00 Kg/m <sup>2</sup>
BARKOD	25.00 kg  8680746480193	5.00 kg  8680746481244	

## BITUMEPOL - 812

SINGLE COMPONENT BITUMEN  
BASED - POLYURETHANE BASED LIQUID  
WATERPROOFING PRODUCT



PACK	A	B	TOTAL
	20.00 kg	20.00 kg	40.00 kg
	7.50 kg	7.50 kg	15.00 kg
CONSUME	1,50 - 2.00 Kg/m <sup>2</sup>	BARKOD	 8680746480209
			 8680746481251

### DESCRIPTION:

- Single component , polyurethane based and ve bitumen contained elastic, elastik, cold applied liquid membrane,
- Makes a film with high elasticity by adhering perfectly to almost all surfaces which applied.
- It forms an elastic and durable film by curing with humidity in the air.

### ADVANTAGES:

- Easy preparation (brush, roll or with airless spray ).
- When applied, it forms a one-piece waterproofing layer that does not cause seams or leaks,
- Hing Stretching,
- Fast curing
- Excellent mechanical properties, high elongation, tensile, tear and abrasion resistance.
- Stable water and frost resistant.
- Heat resistance performance in wide temperature range, it is between -40 °C and + 90 °C.
- Even if the waterproofing layer is damaged in any way the damaged part can be easily repaired in a short time,
- Can be used as a joint material.
- Resistant to chemicals.

### USAGE AREAS:

- Water tank (exluding drinkable water stock),
- Floors,
- Grounds,
- Bridge platforms,
- Open-close tunnels,
- Can be applied in bath, terrace and in the roofs under tiles.
- Retaining Walls,
- Plater and cement panels,
- EPDM membranes,
- Asphalt membranes,
- Green roofs and plant tarhs,
- Lightweight roof(metal or fiber cement),
- Autopark.

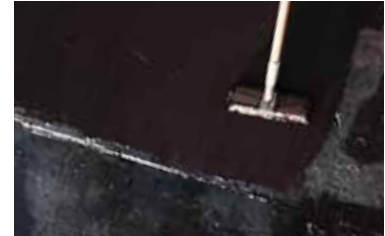

## AQUAPOL 2K - 813

SINGLE COMPONENT SOLVENT FREE POLYURETHANE  
BASED LIQUID WATERPROOFING PRODUCT  
SUITABLE FOR DRINKABLE WATER USAGE



PACK	A	B	TOTAL
	24.00 kg	4.00 kg	28.00 kg
	6.00 kg	1.00 kg	7.00 kg
CONSUME	1,50 - 1.80 Kg/m <sup>2</sup>	BARKOD	 8680746480216
			 8680746481268

### DESCRIPTION:

- Designed for drinkable water stock areas, polyurethane based solvent-free two component, waterproof membrane which apply for protection.

### ADVANTAGES:

- Water stock areas,
- Drinking water distribution channels,
- Irrigation channels,
- Concrate surfaces,
- Plaster and cement panels,
- Internal and external usage areas.

### USAGE AREAS:

- Suitable usage for the drinkable water areas.
- Solvent-free.
- Even if the waterproofing layer is damaged in any way the damaged part can be easily repaired in a short time,
- As being pure polyurethane can continuously contact with water,
- Heat resistance performance in wide temperature range, it is between -40 °C and + 90 °C.
- Resistant to chemicals.



## AQUAPOL TRANS - 814

SINGLE COMPONENT POLYURETHANE BASED TRANSPARENT ALIPHATIC LIQUID WATERPROOFING PRODUCT



### DESCRIPTION:

- Transparent aliphatic polyurethane based, single component, waterproof liquid membrane which apply for protection..

### USAGE AREAS:

- Terraces and balconies,
- Ceramic surfaces,
- Glass surfaces,
- Naturel stones and concretes

### ADVANTAGES:

- Very high mechanic resistant.
- UV resistant.
- Even if the waterproofing layer is damaged in any way the damaged part can be easily repaired in a short time,
- Easy implementation,
- Maintain transparency even after years.
- As being pure polyurethane can contact continuously with water,
- Heat resistance performance in wide temperature range, it is between -40 °C and + 80 °C.
- Even if the waterproofing layer is damaged in any way the damaged part can be easily repaired in a short time,
- Resistant to alkali and chemicals.

PACK	20.00 kg 4.00 kg	CONSUME	0,100 - 0,500 Kg/m <sup>2</sup>
BARKOD	<div> <div>20.00 kg</div> <div>4.00 kg</div> </div> <div>   </div> <div> 8680746480223 8680746481275 </div>		

## AQUAPOL TRANS PR - 815

NGLE COMPONENT ABSORBENT NON-POROUS SURFACE PRIMER



### DESCRIPTION:

- It is a primer which used before polyurethane applying for the surface of the ceramic, glass, glass brick and metals.

### USAGE AREAS:

- Terraces and balconies,
- Ceramic surfaces,
- Glass surfaces,
- Glazed tile,
- Granite,
- Naturel stone and concrete.

### ADVANTAGES:

- Eaisy implementation.
- No thinning is required.
- Ready for use.
- It is applied to ceramic, glass, glass brick, granite ect.surfaces.

PACK	1.00 kg	CONSUME	0,05 - 0,08 Kg/m <sup>2</sup>
BARKOD	<div>  </div> <div>8680746481367</div>		

## AQUA HIBRIT - 1001

HYBRID POLYMER BASED LIQUID WATER INSULATION PRODUCT



### DESCRIPTION:

- Aqua Hibrit-1001 is a waterproof product that hybrid polymer based, isocyanate and solvent-free, silane-reinforced,uv absorber and antioxidant contained,ready for usage.

### ADVANTAGES:

- UV resistant.
- Easy implement( by brush, roll and non-air spray ).
- When appllied, it forms a one-pieace waterproofing layer that does not cause seams or leaks
- No need for primer.
- It does not contain solvents and isocyanates which are harmful to the environment and human health.
- Can be used internal places.
- Moderate flexibility.
- The roof, which is caused by the motion of the building after curing, continues to adhere, close and protect the cracks in the joints that grow at the joints without disturbing its technical characteristics.
- Even if the waterproofing layer is damaged in any way the damaged part can be easily repaired in a short time,

### USAGE AREAS:

- Terraces,
- Open top roofs,
- Wet areas,
- Baths,
- Concrete surfaces,
- Plaster and cement pannels,
- Internal-external application areas,
- Under the covered areas,
- Asphalt waterproofing layers



PACK	5.00 kg 1.00 kg	CONSUME	1,20 - 1,50 Kg/m <sup>2</sup>
BARKOD	<div> <div>5.00 kg</div> <div>1.00 kg</div> </div> <div>   </div> <div> 8680746481282 8680746480247 </div>		

## AQUA HIBRIT TRANS - 1002

HYBRID POLYMER BASED TRANSPARENT WATER INSULATION PRODUCT



PACK	5.00 kg 1.00 kg	CONSUME	0,100-0,500 Kg/m <sup>2</sup>
BARKOD	5.00 kg 8680746481299	1.00 kg 8680746480254	

### DESCRIPTION:

- Aqua Hibrit-1001 is a transparent waterproof product that hybrid polymer based, isocyanate and solvent-free, silane-reinforced, uv absorber and antioxidant contained, ready for usage.

### ADVANTAGES:

- Very high mechanic resistant.
- UV resistant.
- . Even if the waterproofing layer is damaged in any way the damaged part can be easily repaired in a short time,
- Easy implementation,
- Maintain transparency even after years.
- As being pure polyurethane can contact continuously with water,
- .Heat resistance performance in wide temperature range, it is between -40 °C and + 80 °C.
- . Even if the waterproofing layer is damaged in any way the damaged part can be easily repaired in a short time,
- Resistant to alkali and chemicals.

### USAGE AREAS:

- Terrace and Balconies
- Ceramic surfaces
- Glass surfaces
- Naturel stone and concrete



TRANSPARENT TILE

## PURSIS - 833

ACRYLIC RESIN BASED ELASTOMERIC WATERPROOFING PRODUCT



### DESCRIPTION:

- Acrylic – elastomeric resin based, single component, paintable, waterproofing product.

### USAGE AREAS:

- All kind baths, toilet and wet areas,
- Under the ceramic as a insulation product,
- Concrete, screed and plaster surfaces,
- On cement coated surfaces,
- On bitumen surfaces (should be used )

### ADVANTAGES:

- Can be covered by ceramic,
- Very high elastic property,
- Very high degree of crack bridging feature,
- Very high andherence,
- Easy and fast implementation,
- Can be applied with brush and spraying equipment.
- Due to eleatic typify has high resistant to temperature differences,
- %600 stretch.
- Creates a waterproofing layer without joints, seamless, permanent, moisture and waterproof,
- Has high penetration,

PACK	A	B	TOTAL
	225 kg	200 kg	425 kg
CONSUME	2,00 - 2,50 Kg/m <sup>2</sup>		
BARKOD	8680746480261		











## REPAIR MORTARS

## REPAIR - 904

CEMENT BASED HIGH RESISTANCE REPAIR MORTAR -FINE



### DESCRIPTION:

- Cement based, polymer based, high performance, high resistance, resistant to sudden temperature changes, fine-grained surface repair mortar.

### USAGE AREAS:

- For repairment,
- Repairment of the concrete surfaces,
- To filling of the thread holes,
- Creation of corner chamfers,
- Can be used in floor preparation before waterproofing,

### ADVANTAGES:

- Easy and fast preparation.
- High andherance.
- Can be used repairmen of structural.
- Does not shrink.
- Provides high strength for freeze-thaw cycle.
- Does not sag on vertical surfaces.
- Does not do shrinkage cracks.



PACK	25.00 kg	CONSUME	1,70 Kg/dm <sup>3</sup>
BARKOD	 8680746480285		

## REPAIR - 906

MORTAR FOR SURFACE RESTORE

### DESCRIPTION:

- Cement based, polymer based, high performance, high resistance, resistant to sudden temperature changes, fine-grained surface repair mortar.

### USAGE AREAS:

- For repairment,
- Repairment of the concrete surfaces,
- Plastering for roof and walls,
- Creation of corner chamfers,
- Can be used in floor preparation before waterproofing,

### ADVANTAGES:

- Easy and fast preparation.
- High andherance.
- Does not shrink.
- Does not sag on vertical surfaces.
- Does not do shrinkage cracks.
- High performance for each floor usage.



PACK	25.00 kg	CONSUME	1,70 Kg/dm <sup>3</sup>
BARKOD	 8680746481381		



## REPAIR PLUS - 905

CEMENT BASED HIGH RESISTANCE  
CONSTITUTIONAL REPAIR

### DESCRIPTION:

- Cement based, polymer based, high performance, high resistance, resistant to sudden temperature changes, fine-grained surface repair mortar.



**Compressive Strength :  $\geq 60 \text{ N/mm}^2$**   
**Bending Strength:  $\geq 7,5 \text{ N/mm}^2$**

PACK	25.00 kg	CONSUME	1,70 Kg/dm <sup>3</sup>
BARKOD	 8680746480292		



### USAGE AREAS:

- Repairment of the concrete surfaces,
- To filling of the thread holes,
- In order to obtain a solid surface in the gross concrete,,
- Creation of corner chamfers,
- Can be used in floor preparation before waterproofing,



### ADVANTAGES:

- Easy and fast preparation.
- High adherence.
- Can be used repairment of structural.
- Does not shrink.
- Provides high strength for freeze-thaw cycle.
- Does not sag on vertical surfaces.
- Does not do shrinkage cracks.



## D-LEVEL - 750

Самовыравнивающаяся стяжка на цементной основе

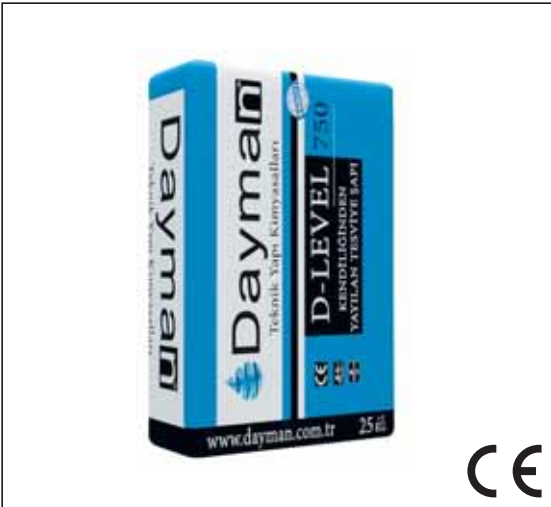

PACK	25.00 kg	CONSUME	1,70 Kg/dm <sup>3</sup>
BARKOD	 8680746480308		

### DESCRIPTION:

- Cement based, it can be applied between 1 to 10 mm. in a shot, easy preading, containing super plasticizer chemicals additives, (self levelling)

### USAGE AREAS:

- Hospital, shopping malls.schools, hotels,
- Exposed to medium and intensive traffic, before the last floor cover of the all structure.
- To create a solid and smooth surface against wear and dust,
- PVC, laminated flooring, wooden, carpet, under the ceramic covers,
- It is used after cement-based surfaces after floor insulation.



### ADVANTAGES:

- Easy and fast preparation.
- Can be applied by mob or trowel.
- Self levelling.
- Suitable for floors exposed to medium and intensive traffic.
- It can be opened to traffic after 6 hours.K
- It became to scale by self levelling,
- It is suitable for application in 1-10 mm thickness without shrinkage cracks.
- Resistant to abrasion..
- Because of the private polymer, It has high adhesion power.



## EPO MORTAR - 855

EPOXY BASED HIGH RESISTANT STRUCTURAL REPAIR MORTAR



PACK	20.00 kg	CONSUME	1,90 Kg/dm <sup>3</sup>
BARKOD	 8680746480339		

### DESCRIPTION:

- Epoxy based, solvent free,coarse gravel,high resistant repairment mortar.

### USAGE AREAS:

- Concrete surfaces repairment,
- Repair of the places such as plant, warehouse, hospital ect,
- As floor covering for high resistance floors,,
- In the installation of dilatation profiles,
- In order to obtain a solid surface in the gross concrete,
- Creation of corner chamfers,
- Can be used on epoxy flooring and pre-waterproof floor preparation

### ADVANTAGES:

- Very high andherance.
- Fast and eaisy preparation.
- Does not do shrinkage cracks.
- Provides the needed performance in a line.
- Fast and eaisy application.
- Can be used in structural repairs.

## EPO GROUT - 858

EPOXY BASED,SOLVENT FREE HIGH RESISTANCE GROUT MORTAR.



PACK	10.00 kg	CONSUME	1,85 Kg/dm <sup>3</sup>
BARKOD	 8680746480346		

### DESCRIPTION:

- Epoxy based,solvent free,liquid, high resistant,quick set grout mortar.

### USAGE AREAS:

- It is used to fix turbines and fill in RES switchboard.
- Suitable for industrial usage,
- To fix the machine feet,
- To fix the steel columns,
- In the assembly of prefabricated concrete building elements,
- Repair of the concrete surfaces,
- Filling of the holes on the concrete.

### ADVANTAGES:

- No need plater.
- Very high adharence.
- Easy- fast preparation and application.
- Liquid.
- Does not do shrinkage cracks.



## D-GROUT - 901

CEMENT BASED, HIGH RESISTANCE GROUT MORTAR

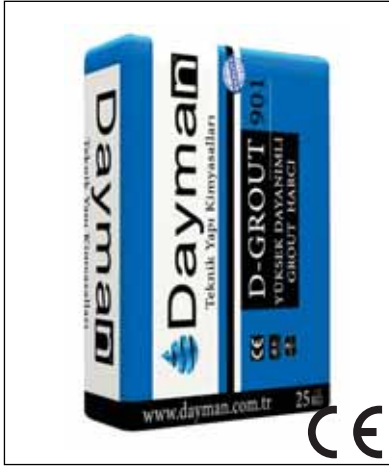

PACK	25.00 kg	CONSUME	1,70 Kg/dm <sup>3</sup>
BARKOD	 8680746480315		

### DESCRIPTION:

- Cement based, polymer modified, high performance, high resistance, resistant to sudden temperature changes, waterproof liquid grout mortar.

### USAGE AREAS:

- In the RES switchboard to fix and fill the tribune works.
  - Installation of manhole covers,
  - In the manufacture of curtains and columns and pile heads,
  - Fixing of the machine feet,
  - At the fixed point of the steel columns,
  - In the assembly of prefabricated concrete building elements,
  - In the repair of concrete surfaces,
- It can be used to fill the vacant spaces.

### AVANTAJLARI:

- Very high adherence,
- Eaisy and fast preparation,
- Does not do shrink crack,
- Eaisy and fast application,
- Provides a high level of resistance in the freeze-thaw cycle.
- Waterproof.



## D-GROUT SPEED - 902

QUICK SET, CEMENT BASED,HIGH RESISTANCE, GROUT MORTAR



PACK	25.00 kg	CONSUME	1,70 Kg/dm <sup>3</sup>
BARKOD	 8680746480322		

### DESCRIPTION:

- Quick set cement based , poliymer modified,having high resistance,resistance to sudden heat difference,waterproof,liquid grout mortar.

### USAGE AREAS:

- In the RES switchboard to fix and fill the tribune works.
- Installation of manhole covers,
- In the manufacture of curtains and columns and pile heads,
- Fixing of the machine feet,
- At the fixed point of the steel columns,
- In the assembly of prefabricated concrete building elements,
- In the repair of concrete surfaces,
- It can be used to fill the vacant spaces.

### ADVANTAGES:

- Very high adherence,
- Eaisy and fast preparation,
- Does not do shrink crack,
- Eaisy and fast application,
- Provides a high level of resistance in the freeze-thaw cycle.
- Waterproof.

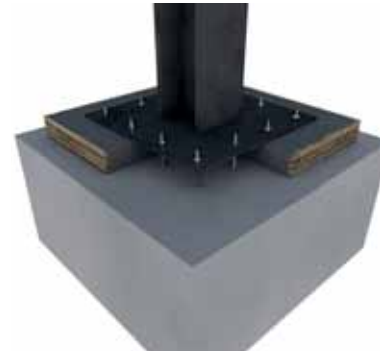







## **CEMENT BASED FLOOR PRODUCTS**

## HARD - C - 700

### SILICA AGREGAL SURFACE HARDENING PRODUCT

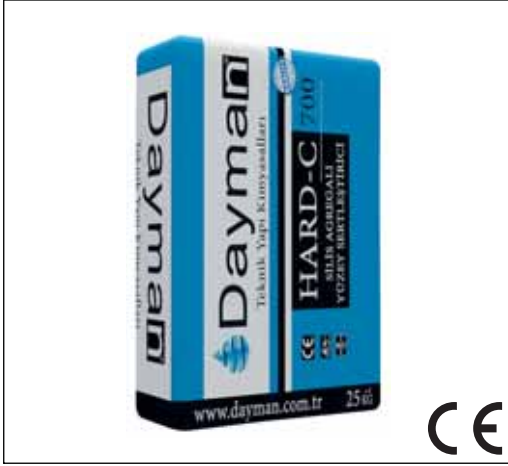

#### DESCRIPTION:

- Hard-C-700 is a hardening product which is cement based, silica agregal, high resistant to wear surface, containing special chemical additive, ready-to use, applied in a powder form.

#### USAGE AREAS:

- Indoors and outdoors,
- To create decorative anti-corrosive coating for industrial building floors,
- To create a ground with high wear resistance in areas exposed to vehicle traffic,
- Factory, warehouse, heliport, underground passages,
- In all mineral based floor covering areas such as parking lot, school, shopping center, metro stations,
- It is used to strengthen the surfaces of bearing concrete and screeds.
- The surface hardener application is to increase the abrasion, dusting and impact strength of the selected concrete on the concrete surface.

#### ADVANTAGES:

- It has much higher strength than concrete surfaces.
- The hardness grade is high.
- Retarding the surface dusting.
- Provides a smooth and homogen appearance.
- Low permeability.
- Has natural decorative appearance.
- Applied easy and practical .
- It is durable to vehicle traffics,
- Easy and fast preaper.



PACK	25.00 kg	CONSUME	4,00 - 6,00 Kg/m <sup>2</sup>
BARKOD	 8680746480353		

## HARD - C - 701

### QUARTZ AGREGAL SURFACE HARDENING PRODUCT



#### DESCRIPTION:

- Hard-C-701 is a hardening product which is cement based, quartz agregal, high resistant to wear surface, containing special chemical additive, ready-to use, applied in a powder form.:

#### USAGE AREAS:

- Indoors and outdoors,
- To create decorative anti-corrosive coating for industrial building floors,
- To create a ground with high wear resistance in areas exposed to vehicle traffic,
- Factory, warehouse, heliport, underground passages,
- In all mineral based floor covering areas such as parking lot, school, shopping center, metro stations,
- It is used to strengthen the surfaces of bearing concrete and screeds.
- The surface hardener application is to increase the abrasion, dusting and impact strength of the selected concrete on the concrete surface.

#### ADVANTAGES:

- It has much higher strength than concrete surfaces.
- The hardness grade is high.
- Retarding the surface dusting.
- Provides a smooth and homogen appearance.
- Low permeability.
- Has natural decorative appearance.
- Applied easy and practical .
- It is durable to vehicle traffics,
- Easy and fast preaper.

PACK	25.00 kg	CONSUME	4,00 - 6,00 Kg/m <sup>2</sup>
BARKOD	 8680746480360		

## HARD - C - 702

CORUNDUM AGREGAL  
SURFACE HARDENING  
PRODUCT



PACK	25.00 kg	CONSUME	1,70 Kg/dm <sup>3</sup>
BARKOD	 8680746480315		

### DESCRIPTION:

- Hard-C-701 is a hardening product which is cement based, quartz agregal, high resistant to wear surface, containing special chemical additive, ready-to use, applied in a powder form.

### ADVANTAGES:

- Indoors and outdoors,
- To create decorative anti-corrosive coating for industrial building floors,
- To create a ground with high wear resistance in areas exposed to vehicle traffic,
- Factory, warehouse, heliport, underground passages,
- In all mineral based floor covering areas such as parking lot, school, shopping center, metro stations,
- It is used to strengthen the surfaces of bearing concrete and screeds.
- The surface hardener application is to increase the abrasion, dusting and impact strength of the selected concrete on the concrete surface.

### USAGE AREAS

- It has much higher strength than concrete surfaces.
- The hardness grade is high.
- Retarding the surface dusting.
- Provides a smooth and homogen appearance.
- Low permeability.
- Has natural decorative appearance.
- Applied easy and practical .
- It is durable to vechile traffics,
- Easy and fast prepare

## AC - CURE - 710

ACRYLIC BASED  
CONCRETE PRODUCT



PACK	30.00 kg	CONSUME	0,200-0,250 Kg/m <sup>2</sup>
BARKOD	 8680746480384		

### DESCRIPTION:

- Acrylic, water, acrylic emulsion, concrete, alum and cement based, a concrete curing material used on surfaces to form a mechanical resistance enhancing layer on the surface.

### USAGE AREAS:

- Indoor and outdoor,
- In all site concretes
- After the surface hardener,
- Can be used in horizontal and vertical concrete construction elements for curing.

### ADVANTAGES

- Prevents rapid water loss from newly spilled concrete.
- It keeps the water in concrete for hydration.
- It is more economical than other curing methods.
- Can be used indoors.
- Solvent free
- It prevents cracks in the retraction.
- Eaisy and fast implementation.

## P - CURE - 711

PARAFFIN BASED  
CONCRETE PRODUCT

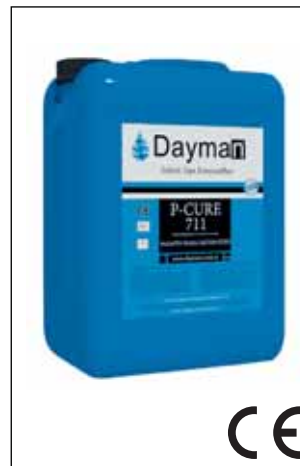

PACK	10.00 kg	CONSUME	0,200-0,250 Kg/m <sup>2</sup>
BARKOD	 8680746480391		

### DESCRIPTION:

- Acrylic, water, acrylic emulsion, concrete, alum and cement based, a concrete curing material used on surfaces to form a mechanical resistance enhancing layer on the surface.

### USAGE AREAS:

- Indoor and outdoor,
- In all site concretes
- After the surface hardener,
- Can be used in horizontal and vertical concrete construction elements for curing.

### ADVANTAGES:

- Prevents rapid water loss from newly spilled concrete.
- It keeps the water in concrete for hydration.
- It is more economical than other curing methods.
- Can be used indoors.
- Solvent free
- It prevents cracks in the retraction.
- Eaisy and fast implementation.



## DECO C - 740

### STAMPED CONCRETE SURFACE HARDENER PRODUCT



AMBALAJ	25.00 kg	TÜKETİM	3,00 - 4,00 Kg/m <sup>2</sup>
BARKOD	 8680746480407		

#### DESCRIPTION:

Cement based, produced for private concrete stamping. It is a surface hardening product which is applied by spraying with the ready powder

#### USAGE AREAS:

- Villa
- Car park
- Pedestrian Street
- School
- Park
- Shopping Centres
- It can be applied very successfully on all surfaces that can produce concrete with desired decorative appearance.

#### ADVANTAGES :

- Unlimited designs can be made with different forms.
- Extremely decorative and natural appearance..
- Second color options can be increased with DAYMAN DECO C POWDER.
- Natural decorative appearance.
- Has higher strength than concrete surfaces.
- High hardness degree.
- Delays surface dusting.
- Provides a smooth and homogeneous appearance.
- Low permeability.
- Easy and practical application.
- Resistant to vehicle traffic and high load.
- Easy and fast use.

## DECO C POWER - 742

### STAMPED CONCRETE DECORATIVE PRODUCT



AMBALAJ	25.00 kg	TÜKETİM	0,200 – 0,400 kg/m <sup>2</sup>
BARKOD	 8680746480414		

#### DESCRIPTION:

Cement based, produced for private concrete stamping. It is a surface hardening product which is applied by spraying with the ready powder

#### USAGE AREAS:

- Villa
- Car park
- Pedestrian Street
- School
- Park
- Shopping Centres
- It can be applied very successfully on all surfaces that can produce concrete with desired decorative appearance.

#### ADVANTAGES :

- Unlimited designs can be made with different forms.
- Extremely decorative and natural appearance..
- Second color options can be increased with DAYMAN DECO C74 POWDER.
- Natural decorative appearance.
- Has higher strength than concrete surfaces.
- High hardness degree.
- Delays surface dusting.
- Provides a smooth and homogeneous appearance.
- Low permeability.
- Easy and practical application.
- Resistant to vehicle traffic and high load.
- Easy and fast use.

## DECO - C FINISH - 743

### PRINT CONCRETE POLISH



AMBALAJ	15.00 kg	TÜKETİM	0,300 – 0,400 kg/m <sup>2</sup>
BARKOD	 8680746480421		

#### DESCRIPTION:

- Solvent based, transparent printing concrete which gives glossy appearance, maintains decorative appearance in the printing concrete system.

#### USAGE AREAS:

- All printing concrete surfaces
- Absorbent surfaces that require gloss
- and protection.

#### ADVANTAGES :

- Provides aesthetic appearance by adding sparkles to the floor where it is applied.
- Extremely decorative and natural appearance..
- Prevent surface dusting
- Provides a smooth and homogeneous appearance.
- Low permeability.







## **EPOXY BASED FLOOR PRODUCTS**



## EPO - PR - 850

SOLVENT BASED TWO COMPONENT- HIGH RESISTANT EPOXY PRIMER



PACK	A	B	TOTAL
	17.00 kg	8.00 kg	25.00 kg
CONSUME	0,200 – 0,500 Kg/m <sup>2</sup>		
	BARKOD	 8680746480438	

### DESCRIPTION:

- Epoxy based,two componenet,low viscosity,high resistance primer product.

### USAGE AREAS:

- Indoor and outdoor,
- Shoppig mall, super market,
- Protective coating in industrial surface systems,
- Sewerage and waste facilities,
- Autopark, walking trails,
- Paper clay and paper factories,
- Used as a primer for PU and epoxy systems.

### ADVANTAGES:

- Solvent free.
- Easy application.
- Provides excellent adhesion with absorbent surfaces.
- It perfectly covers the surface homogeneously.
- Fast application,
- Creates a bright film.
- It is resistant to general cleaning chemistry.
- Can be used as primer for all epoxy products



## EPO PR WT – 851

SOLVENT BASED TWO COMPONENT HUMIDITY TOLERANCED HIGH RESISTANT EPOXY PRIMER



PACK	A	B	TOTAL
	7.50 kg	2.50 kg	10.00 kg
CONSUME	0,200 – 0,600 Kg/m <sup>2</sup>		
	BARKOD	 8680746480445	

### DESCRIPTION:

- Epoxy based,two componenet,low viscosity,high resistance primer product.

### USAGE AREAS:

- Indoor and outdoors,
- Shoppig mall, super market,
- Sewerage and waste facilities,
- Autopark, walking trails,
- Paper clay and paper factories,
- Used as a primer for PU and epoxy systems.

### ADVANTAGES:

- Works as a barrier against water and moisture at high temperatures.
- Used as a coating primer for damp concrete surfaces.
- Solvent free.
- Eaisy application.
- Odorless and non-flammable
- Provides excellent adhesion with absorbent surfaces.
- It perfectly covers the surface homogeneously.
- Fast application,
- Creates a bright film.
- It is resistant to general cleaning chemistry.
- Protective coating in industrial surface systems



## EPO - SELF - 854

SOLVENT FREE EPOXY COATING – SELF LEVELING WITH TWO COMPONENTS



### DESCRIPTION:

- Epoxy-based, two-component, chemically curing, solvent-free self-leveling epoxy topcoat.

### USAGE AREAS:

- Indoor,
- Food production facilities,
- Warehouse and plants,
- Shopping mall and super markets,
- Protective coating in industrial surface systems,
- Sewerage and waste facilities,
- Can be used in paper clay and paper mills.

### ADVANTAGES:

- High chemical resistance.
- Solvent free.
- Eaisy application.
- Has high mechanical strength.
- Dry in short-term .
- It perfectly covers the surface homogeneously.
- Fast application.

PACK	A	B	TOTAL
	15.00 kg	5.00 kg	20.00 kg
CONSUME	0,500 – 2,00 Kg/m <sup>2</sup>		
	BARKOD	 8680746480476	



## EPO - SAND - 860

EPOKSİ KUMU 03- 03



### DESCRIPTION:

- Quartz sand used in epoxy floor coatings.



PACK	25.00 kg	CONSUME	Variance
BARKOD	 8680746480483		

## EPO - SAND - 856

EPOKSİ KUMU 03- 08

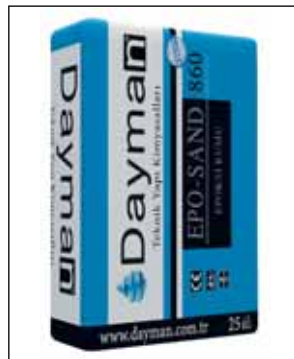

### DESCRIPTION:

- Quartz sand used in epoxy floor coatings.



PACK	25.00 kg	CONSUME	Variance
BARKOD	 8680746480490		

## EPO - PAINT - 852

EPOXY COVER SOLVENT FREE HIGH RESISTANT WITH TWO COMPONENT



### DESCRIPTION:

- Epoxy based, two component, chemically cured, solvent free epoxy topcoat with high chemical and physical strength.



PACK	A	B	TOTAL
	16.00 kg	4.00 kg	20.00 kg
CONSUME	0,200 – 0,600 Kg/m <sup>2</sup>		
	BARKOD	 8680746480452	

### USAGE AREAS:

- Warehouse and plants,
- Indoor,
- Shopping mall and super markets,
- Protective coating in industrial surface systems,
- Sewerage and waste facilities,
- Can be used in paper clay and paper mills.

### ADVANTAGES:

- High chemical resistance.
- Solvent free.
- Easy application.
- Has high mechanical strength.
- Dry in short-term .
- It perfectly covers the surface homogeneously.
- Fast application.
- Creates a bright film.



## EPO - PAINT TX – 853

EPOXY COVER SOLVENT FREE,HIGH RESISTANT,TWO COMPONENT WITH ORANGE PEEL PATTERN



PACK	A	B	TOTAL
	17.00 kg	3.00 kg	20.00 kg
CONSUME	0,500 – 0,800 Kg/m <sup>2</sup>		
	BARKOD		
			8680746480469

### DESCRIPTION:

- Epoxy based, orange peel designed with two component, chemically cured, solvent free epoxy topcoat with high chemical and physical strength.

### USAGE AREAS:

- High chemical resistance.
- Solvent free.
- Eaisy application.
- Has high mechanical strength.
- Dry in short-term .
- It perfectly covers the surface homogeneously.
- Fast application.
- Creates a bright film.

### ADVANTAGES:

- High chemical resistance.
- Solvent free.
- Eaisy application.
- Has high mechanical strength.
- Dry in short-term .
- It perfectly covers the surface homogeneously.
- Fast application.
- Creates a bright film.

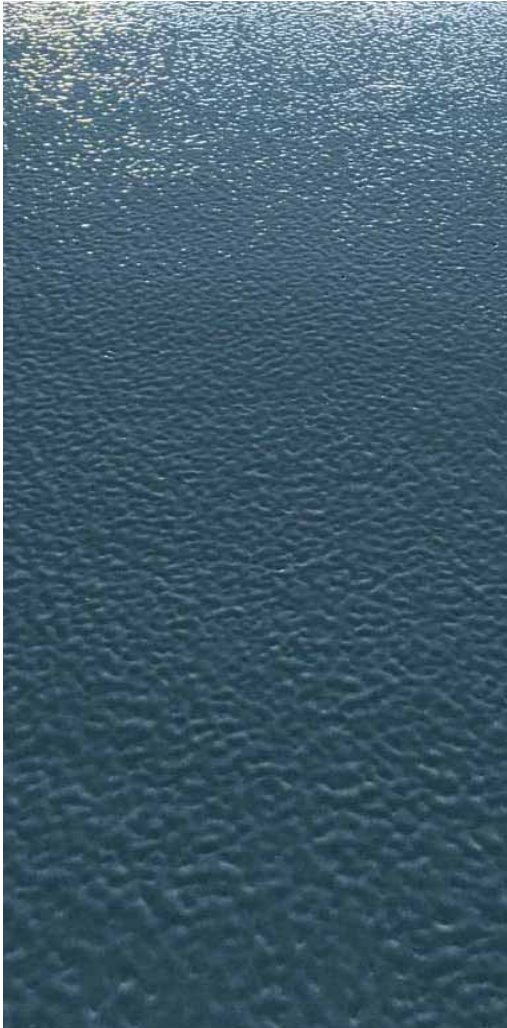









**CERAMIC  
ADHESIVE AND  
JOINT FLUIDS**

## CERA-CEM - 908 (C1 TE)

HIGH PERFORMANCE CERAMIC ADHESION MORTAR



PACK	25.00 kg	CONSUME	4,00 - 6,00 Kg/m²
BARKOD	 8680746480506		

### DESCRIPTION:

It is a cement based, high stability slip reducing ceramic adhesive mortar.

### USAGE AREAS:

Ceramic, tile, glass mosaic, marble and ect.

Indoor Applications:

- Bath, WC, kitchen, wet areas.
- Wall and floor.
- Outdoor Applications,
- Floor

### ADVANTAGES

- Easy and fast preparation.
- High adherence..
- Saves from labors.



## CERA-CEM PLUS - 909 (C2 TE)

HIGH PERFORMANCE CERAMIC, PORCELAIN AND GRANITE ADHESION MORTAR



PACK	25.00 kg	CONSUME	3,50 - 5,00 Kg/m²
BARKOD	 8680746480513		

### DESCRIPTION:

- It is a cement based, high stability and has capacity to work long time, slip reducing ceramic adhesive mortar.

### USAGE AREAS:

Ceramic, tile, glass mosaic, marble and ect. coating material.

Indoor Applications:

- Bath, WC, kitchen, wet areas.
- Wall and floor.
- Outdoor Applications,
- Floor

### ADVANTAGES:

- Easy and fast preparation.
- Flexible.
- Has extended working time
- high adherence.
- Saves from labors.



## CERA-CEM FLEX - 910 (C2 TE S1)

HIGH PERFORMANCE FLEXIBLE CERAMIC,  
PORCELAIN AND GRANITE ADHESIVE MORTAR



PACK	25.00 kg	CONSUME	3,50 - 5,00 Kg/m <sup>2</sup>
BARKOD	 8680746480520		

### DESCRIPTION:

- It is a cement based, high stability and has capacity to work long time, slip reducing ceramic, granite adhesive mortar.

### USAGE AREAS:

Ceramic, tile, glass mosaic, marble, granite and similar product's coating materials.

#### Indoor Applications:

- All vertical and horizontal surfaces,
- Bath, WC, kitchen, wet areas,
- Wall and floor,
- Balcony and terraces,
- Extensive areas.

#### Outdoor Applications:

- Flooring
- Wall

### ADVANTAGES:

- Easy and fast preparation.
- Has an extended working time.
- Flexible.
- Has extended working time
- High adherence.
- Saves from labors.



## CERA-CEM FLEX -W - 911 (C2 TE S1)

WHITE, HIGH PERFORMANCE FLEXIBLE CERAMIC,  
PORCELAIN AND GRANITE ADHESIVE MORTAR

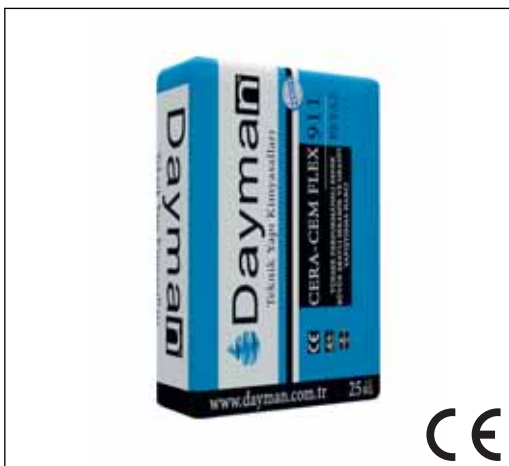

PACK	25.00 kg	CONSUME	3,50 - 5,00 Kg/m <sup>2</sup>
BARKOD	 8680746480537		

### DESCRIPTION:

- It is a cement based, high stability and has capacity to work long time, slip reducing ceramic, granite adhesive mortar.

### USAGE AREAS:

Ceramic, tile, glass mosaic, marble, granite and similar product's coating materials

#### Indoor Applications:

- All vertical and horizontal surfaces,
- Bath, WC, kitchen, wet areas,
- Wall and floors,
- Balcony and terraces,

#### Outdoor Application:

- Floor
- Wall

### ADVANTAGES:

- Easy and fast preparation.
- Has an extended working time.
- Flexible.
- Has extended working time
- High adherence.
- Saves from labors.





## CERA-CEM FLEX 2 K - 912 (C2 FTE S2)

HIGH PERFORMANCE ULTRA FLEXIBLE CERAMIC, PORCELAIN AND GRANITE ADHESION HARCİ



### DESCRIPTION:

- Flexible, cement and acrylic based, high stability, extra flexible, reduced slip properties, long working time, ceramic, porcelain and granite bonding mortar.

### ADVANTAGES:

- Easy and fast preparation.
- Has an extended working time.
- Ultra Flexible.
- Has extended working time
- High adherence.
- Saves from labors.
- Suitable working from top to bottom

### USAGE AREAS:

Seramic, tile, glass mosaic, marble, granite and similar materials:

Indoors Applications:

Pools.

All vertical and horizontal areas.

Bath, WC, kitchen, wet areas.

Wide.

Outdoor Applications:

Balcony and terraces,

Exterior vertical areas,

Pedestrian streets with heavy traffics,

Swimming pools,

PACK	A	B	TOTAL
	25.00 kg	10.00 kg	35.00 kg
CONSUME	3,50 – 5,00 Kg/m <sup>2</sup>		
BARKOD			8680746480544

## CERA-EPO - 915

EPOXY BASED, TWO COMPONENT, CHEMICAL RESISTANT CERAMIC ADHESIVE AND JOINT FILLERS



### DESCRIPTIONS:

- Epoxy based two componenets, resistant to chemicals, seramic adhesive and joint filler materials.

### ADVANTAGES:

- Used both indoors and outdoors.
- Suitable use in heavy traffics,
- Suitable use in swimming pools,
- Easy and fast preparation,
- High mechanical and chemical resistance.
- High-grade adhesion.
- Resistant to frost thaw cycle.
- It is used safely in big size ceramics.

### USAGE AREAS:

To fill the joints of the seramic, tile, glass mosaic, marble and similar coating materials.

Indoor Applications;

- Banth, WC, kitchen, wet areas,
- Wall and floor.

Outdoor Applications;

- Balcony, Terraces,
- Exterior places



PACK	5.00 kg	CONSUME	Please use the table of the joit use datas.
BARKOD			
	8680746480575		

## CERA- FUGA - 913

### SILICONE FILLING JOINT MORTAR



PACK	20.00 kg	CONSUME	Please use the table of the joint use datas.
BARKOD	 8680746480551		

#### DESCRIPTION:

Cement based, can be used between 1-6 mm joint ranges, single component, polymer additive, flexible, abrasion resistant, joint filling material.

#### ADVANTAGES:

- Easy and fast preparation,
- Silicone additive,
- Abrasion resistant,
- It is applied without damaging the glazed surfaces.
- Adhesion strength is excellent.
- Suitable for 1-6 mm joint fillings.

#### USAGE AREAS:

To fill the joints of the ceramic, tile, glass mosaic, marble and similar coating materials.

Indoor Applications,  
Bath, WC, kitchen, wet areas  
Wall and flooring



## CERA-FUGA FLEX – 914

### WHITE, HIGH PERFORMANCE , FLEXIBLE CERAMIC, PORSCELAIN AND GRANITE ADHESIVE MORTAR



PACK	20.00 kg	CONSUME	Please use the table of the joint use datas.
BARKOD	 8680746480568		

#### DESCRIPTION:

Cement based, can be used between 1-6 mm joint ranges, single components, polymer additive, flexible, abrasion resistant, joint filling material.

#### ADVANTAGES:

- Used outdoors,
- Suitable use in swimming pools,
- Easy and fast preparation,
- Silicone additive,
- Abrasion resistant,
- It is applied without damaging the glazed surfaces.
- Adhesion strength is excellent,
- Resistant to freeze-thaw cycling.
- Safe usage with big size ceramics.
- It is used safely in big size ceramics.
- Suitable for 1-6 mm joint fillings.

#### USAGE AREAS:

To fill the joints of the ceramic, tile, glass mosaic, marble and similar coating materials.

Indoor applications:

- Bath, WC, kitchen, wet areas,
- Wall and floor



Outdoor Applications;  
• Balcony, terraces,  
• Exterior areas,







## MORTAR ADDITIVES



## VISCO - C - 501

WATERPROOF ADDITIVE



### DESCRIPTION:

Waterproof for mortar and concrete.

### USAGE AREAS:

- Water , mortar, concrete, screed production,
- Waterproof plaster mortar,
- Waterproof brick mortar,
- To increase the water impermeability of precast facade elements,
- All cement, lime based mortars can be used.
- Can be used in tunnels, bases, culverts, channels, swimming pools

### ADVANTAGES:

- It has a water repellent feature.
- Spill cap prevents water absorption.
- Used in machine plasters.
- Ready for use.

PACK	30.00 kg 5.00 kg	CONSUME	Cement ratio 2% to 3%
BARKOD	30.00 kg  8680746480582	5.00 kg  8680746481305	

## LATEX C - 502

ACRYLIC EMULSION BASED WATER ABSORPTION AND ADHERANCE



### DESCRIPTION:

Acrylic emulsion based additive that increases the elasticity, adherence and water impermeability of the mortar used.



### USAGE AREAS:

- Repairment mortar,
- Ceramic, tile and stone adhesive,
- In coarse and fine plaster mortars,

### ADVANTAGES:

- Elasticity prevents cracking.
- Increase expenditure adherence.
- Increases the strength of spending.
- It has a water repellent feature.
- Spill cap prevents water absorption.
- Used in machine plasters.
- Ready for use.



PACK	30.00 kg 5.00 kg	CONSUME	Cement ratio 5% to 20%
BARKOD	30.00 kg  8680746480605	5.00 kg  8680746481329	



PACK	200.00 kg 30.00 kg	CONSUME	Cement ratio 2%
BARKOD	200.00 kg  8680746481312	30.00 kg  8680746480599	



## CRYSTA C - 503

LIQUID CRYSTALLIZATION CONCRETE ADDITIVES  
FOR CONCRETE AND MORTARS

### DESCRIPTION:

- It is a concrete and mortar admixture which prevents the progress of the water with the effect of creating crystals for the concrete used.

### USAGE AREAS:

- Lay concrete,
- Curtain concrete,
- In the tunnel and metro projects,
- In sewage and treatment plants,
- On retaining walls,

### ADVANTAGES:

- Provides structural water insulation,
- Labor cost is low.
- Works in negative and positive direction.
- Protect equipment from corrosive effects.
- Live with concrete.
- Fills cracks of 0,40 mm thickness by forming crystals.
- Spill cap prevents water absorption.
- Used in machine plasters,
- Ready for use









## HEAT INSULATION SYSTEMS



## D-THERM - 550

### CARBON CONTAINED HEAT INSULATION PLATE



#### DESCRIPTION:

- Carbon contained, low heat-transfer coefficient, heating insulation plate.

#### ADVANTAGES:

- Low heat-transfer coefficient.
- Easy application.

#### USAGE AREAS:

- DAYMAN D-THERM is used as insulation plate in heat-transfer coefficient



PACK	Variable by thickness	CONSUME	1,00 m <sup>2</sup> /m <sup>2</sup>
BARKOD	 8680746480612		

## D-THERM - 557

### HEAT INSULATION FIXTURE PIN



#### DESCRIPTION:

- The pin is used to fix the heating insulation plates.

#### ADVANTAGES:

- Mechanically connects the system to the building.

#### USAGE AREAS:

- DAYMAN D-THERM The pin is used to fix the heating insulation plates.

PACK	500 adet	CONSUME	6 - 8 adet/m <sup>2</sup>
BARKOD	 8680746480681		

## D-TEX 160 2810

### JACKETING APPLICATION FILES



#### DESCRIPTION:

- Alkali-resistant, reinforcement files for mantle applications.

#### ADVANTAGES:

- It prevents the spreading of the mantle.
- Alkali resistant,
- Resistant to temperature changes.
- Easy application
- No shrinkage or puddling.

#### USAGE AREAS:

Is used in DAYMAN D-THERM 552.

PACK	50,00 m <sup>2</sup> rulo	CONSUME	1,10 m <sup>2</sup> /m <sup>2</sup>
BARKOD	 8680746480698		

## D-THERM - 559

### FILIAL CORNER PROFILE

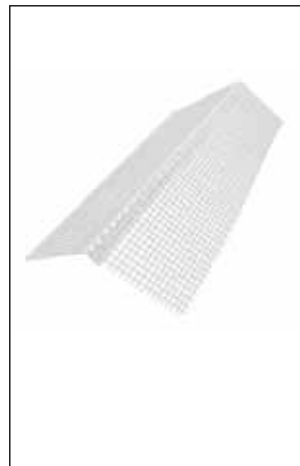

#### DESCRIPTION:

- Corner file profile for alkali resistant and jacketing application.

#### ADVANTAGES:

- It provides to has smooth corner during the jacketing apply.
- Alkali resistant.
- Resistant to temperature changes.
- Easy application.

#### USAGE AREAS:

Is used in DAYMAN D-THERM 552.

PACK	62,50 mt	CONSUME	0,25 mt/m <sup>2</sup>
BARKOD	 8680746480704		

## D-THERM - 551

POLYMER REINFORCED HEAT INSULATION PLATE ADHESIVE

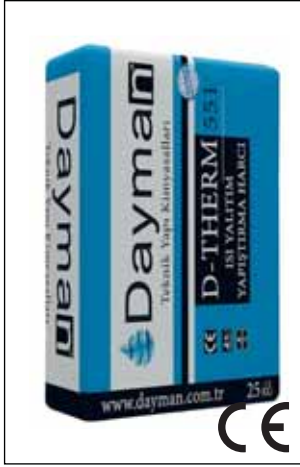

### DESCRIPTION:

- Cement based, polymer reinforced, special chemicals additives are contained, single component heating insulation adhesive plates.

### ADVANTAGES:

- Adheres perfectly to mineral surfaces.
- Easy to apply.
- Water vapor permeable,
- Resistant to freeze-thaw cycle.
- Easy application,
- Long working time .

### USAGE AREAS:

- Indoor and outdoor,
- For sheathing as an adhesive,
- On all mineral surfaces as a repairment mortar,

PACK	25.00 kg	CONSUME	4,00 - 6,00 kg/m <sup>2</sup>
BARKOD	 8680746480629		

## D-THERM - 552

POLYMER BASED HEATING INSULATION MORTAR

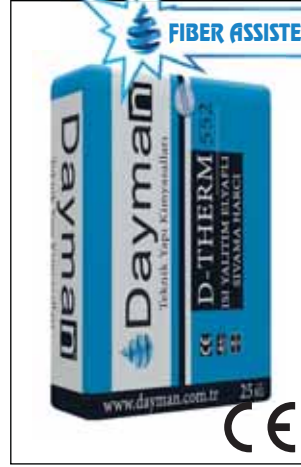

### DESCRIPTION:

- Cement based, polymer reinforced, special chemicals additives are contained, single component heating insulation adhesive plates mortar,

### ADVANTAGES:

- Adheres perfectly to mineral surfaces.
- Easy to apply.
- Water vapor permeable,
- Resistant to freeze-thaw cycle.
- Easy application,
- Long working time .

### USAGE AREAS:

- Indoor and outdoor,
- As an adhesive and plaster in the production of sheathing,
- As a surface repair mortar on all mineral surfaces,
- As a repairment mortar, before painting.

PACK	25.00 kg	CONSUME	4,00 - 6,00 kg/m <sup>2</sup>
BARKOD	 8680746480636		

## D-THERM - 553

TANE DOKULU SON KAT DEKORATİF SIVA

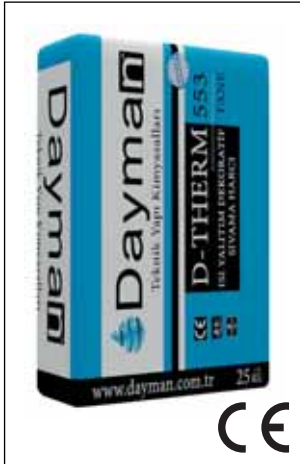

### DESCRIPTION:

Cement based, granular, containing private chemicals additive, decorative plaster applied on top coat with water repellent properties

### ADVANTAGES:

- Adheres perfectly to mineral surfaces.
- Easy to apply.
- Water vapor permeable,
- Resistant to freeze-thaw cycle.
- Easy application,
- Long working time .

### USAGE AREAS:

- It provides excellent adherence both indoors and outdoors.
- Water vapor permeable,
- Resistant to freeze-thaw cycle.
- As an adhesive and plaster in the production of sheathing,
- On all mineral surfaces as repairment mortar,
- As a repairment mortar, before painting (water-based)

PACK	25.00 kg	CONSUME	2,50 - 3,50 kg/m <sup>2</sup>
BARKOD	 8680746480643		

## D-THERM - 554

STRIPE SHEAPED, TOP LAY DEKORATİF MORTAR

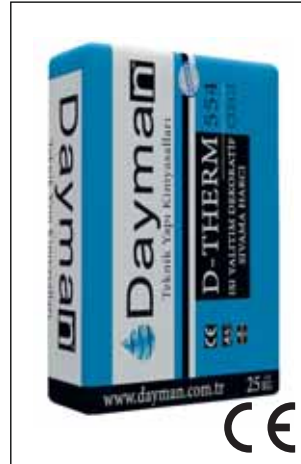

### DESCRIPTION:

It is a top lay decorative mortar which is cement based, stripe sheaped, contains private chemicals additive, has water\*repellent properties.

### ADVANTAGES:

- Adheres perfectly to mineral surfaces.
- Easy to apply.
- Water vapor permeable,
- Resistant to freeze-thaw cycle.
- Easy application,
- Long working time .

### USAGE AREAS:

- It provides excellent adherence both indoors and outdoors.
- Water vapor permeable,
- Resistant to freeze-thaw cycle.
- As an adhesive and plaster in the production of sheathing,
- On all mineral surfaces as repairment mortar,
- As a repairment mortar, before painting (water-based)

PACK	25.00 kg	CONSUME	2,50 - 3,50 kg/m <sup>2</sup>
BARKOD	 8680746480650		

## D-THERM - 555

### EXTERIOR PAINTING



PACK	15.00 Lt kova (20.00 kg)	CONSUME	0,35 - 0,45 kg/m <sup>2</sup>
BARKOD	 8680746480667		

#### DESCRIPTION:

- Waterproof, acrylic emulsion based, top coat application exterior paint.,

#### USAGE AREAS:

- Especially in the last coat of DAYMAN heating insulation system
- Plastered exterior walls,

#### ADVANTAGES:

- High covering property.
- Adheres perfectly to mineral surfaces.
- Easysy preaper.
- Water vapor permeable.
- Water spiller.
- The color option is wide.



## D-THERM - 556

### EXTERIOR WALL PRIMER



PACK	15.00 Lt kova	CONSUME	0,100 - 0,200 lt/m <sup>2</sup>
BARKOD	 8680746480674		

#### DESCRIPTION:

- Waterproof, acrylic emulsion based, top coat application exterior paint.

#### USAGE AREAS:

- D-THERM 555 Under the exterior paint,,
- Under the D-THERM 554 – D-THERM 553 ,
- Can be used as a primer for all acrylic based products.

#### ADVANTAGES:

- Increase the first lay's adherence with the paint which is covered on it.
- Balance the painting consume.
- Suitable usage for acrylic mortars.
- Adheres perfectly to mineral surfaces.
- Easysy preaper.
- Water vapor permeable.











## ANCILLARY PRODUCTS

### D-TEX 45 - 2800

WATER INSULATION APPLYING WALL



PACK	50 m <sup>2</sup> rulo	CONSUME	1,10 m <sup>2</sup> /m <sup>2</sup>
BARKOD	 8680746480711		

#### DESCRIPTION:

- Alkali resistant fitting mesh, improved for the waterproof applications.

#### USAGE AREAS:

Is used during the followed items applys:

- DAYMAN BITUMEN 300 PLUS
- DAYMAN BITUMEN 302
- DAYMAN BITUMEN 303
- DAYMAN D-LASTIC 424
- DAYMAN D-LASTIC PLUS 425
- DAYMAN D-LASTIC SÜPER 430
- DAYMAN D-LASTIC SÜPER X 427
- DAYMAN D-LASTIC SÜPER UV 426

#### ADVANTAGES:

- Balance the consume of the insulation products.
- Alkali dayanımlıdır.
- It is resistant to temperature changes.
- Eaisy application.
- No shrinkage or puddling.



### AQUATEX - 2700

TEXTILE MEMBRANE FOR THE UNDER CERAMIC APPLICATIONS



PACK	30.00 m <sup>2</sup> /rulo	CONSUME	1,07 m <sup>2</sup> /m <sup>2</sup>
BARKOD	 8680746480728		

#### DESCRIPTION:

- Textile membrane which produced for the under ceramic insulation.

#### USAGE AREAS:

- All the under ceramic surfaces,
- Plaster and cement pannels,
- Indoor and outdoor application areas,
- Terraces,
- Wet areas,
- Baths.

#### ADAVANTAGES:

- Faster,
- Eaisy application.
- The cracks can be bridged.
- Alkali resistant.
- Resistant to chemicals.

## DK 100 - 2900

### POLYSTER FELT



PACK	50.00 m <sup>2</sup> rulo	CONSUME	1,00 mt/mt
BARKOD	 8680746480735		

#### DESCRIPTION:

- Polyester felt, for use in sliding waterproofing products as a corner band.

#### USAGE AREAS:

Can be used with the application of the followed products:

- DAYMAN BITUMEN PLUS 300
- DAYMAN BITUMEN 302
- DAYMAN BITUMEN 303
- DAYMAN AQUAFLEX 200
- DAYMAN AQUAFLEX UV 202
- DAYMAN AQUAPOL 810
- DAYMAN AQUAPOL UV 811
- DAYMAN BITUMEPOL 812
- DAYMAN AQUAPOL 2K 813
- DAYMAN AQUA HIBRIT 1001
- DAYMAN AQUA HIBRIT TRANS 1002

#### ADVANTAGES:

- Economic,
- Faster,
- Eaisy application,
- The cracks can be bridged,
- Alkali resistant,
- Resistant to chemicals..

## TEX BAND - 2910

### TEXTİLE MEMBRANE UNDER CERAMIC APPLICATION



PACK	50.00 mt/rulo 12 cm genişlik	CONSUME	1,00 mt/mt
BARKOD	 8680746481374		

#### DESCRIPTION:

- Produced for the waterproofing applies under the ceramic

#### USAGE AREAS:

- All the under ceramic surfaces,
- Plaster and cement pannels,
- Indoor and outdoor application areas,
- Terraces,
- Wet areas,
- Baths.

#### ADVANTAGES:

- Faster,
- Eaisy application,
- The cracks can be bridged,
- Alkali resistant,
- Resistant to chemicals.

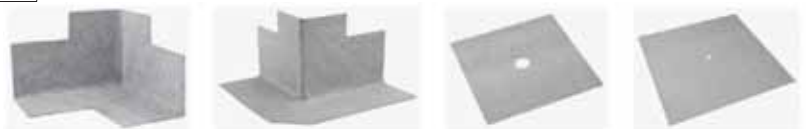



## D-BAND 120 - 2600

### WATERPROOF TAPE



PACK	50.00 mt / roll Width of 10-20 cm	CONSUME	1,00 mt/mt
BARKOD	 8680746480766		

#### DESCRIPTION:

- D-Band 120 is the tape is made with mesh, middle side is made with elastomeric product.
- Alkali resistant D-BAND 120 AR.

#### USAGE AREAS:

- Can be used with the all kind of spreadble waterproof product.
- For the cement based products should be used D-BAND 120 AR.

#### ADVANTAGES:

- Economic,
- Faster,
- Eaisy appy,
- Can be bridged the cracks,
- Alkali resistant,
- Resistant to chemicals,



## D-BAND 120 AR - 2610

### ALKALI RESISTANT-WATERPROOF TAPE



PACK	50.00 mt / roll Width of 10-20 cm	CONSUME	1,00 mt/mt
BARKOD	 8680746480773		

#### DESCRIPTION:

- D-Band 120 is the tape is made with mesh, middle side is made with elastomeric product.
- Alkali resistant D-BAND 120 AR.

#### USAGE AREAS:

- Can be used with the all kind of spreadble waterproof product.
- For the cement based products should be used D-BAND 120 AR.

#### ADVANTAGES:

- Economic,
- Faster,
- Eaisy appy,
- Can be bridged the cracks,
- Alkali resistant,
- Resistant to chemicals,



## D-BAND 20/25/30/40

### DILATATION WATERPROOF TAPE



#### DESCRIPTION:

- Dilatation tape is produced from FPO, in use of the indoor and outdoor areas for the building and dilatation void's insulation.

#### USAGE AREAS:

- Can be used with all spreadble waterproofing products.

#### ADVANTAGES:

- Provides permanent waterproofing in dilatations.
- Eaisy applicarion.
- Can be bridged the cracks.

PACK	20.00 mt/rulo	CONSUME	1,00 mt/mt
BARKOD	D-BAND 20 8680746480780	D-BAND 25 8680746480797	
	D-BAND 30 8680746480803	D-BAND 40 8680746480810	



## AQUABAND AC - 5x20 - 10x20

### ACRYLIC BASED SWELLABLE TAPE



#### DESCRIPTION:

- It is a swelling band that plugs in cracks and voids and blocks water channels by self-inflating in contact with acrylic-based water.

#### ADVANTAGES

Provides lifetime protection by working infinitely reversibly

MEASURE	5x20	PACK	20 mt/rulo
	10x20		10 mt/rulo
BARKOD	5x20 8680746480841		
	10x20 8680746480858		



## AQUABAND BT 5X20- 10X20 - 20x25

### DILATATION WATERPROOF TAPE



#### DESCRIPTION:

- Dilatation tape is produced from FPO, in use of the indoor and outdoor areas for the building and dilatation void's insulation.

#### USAGE AREAS:

- Can be used with all spreadble waterproofing products.

#### ADVANTAGES

- Provides permanent waterproofing in dilatations.
- Eaisy applicarion.
- Can be bridged the cracks,

MEASURE	5x20	PACK	10 mt/rulo
	10x20		10 mt/rulo
BARKOD	25x20 8680746480827		
	10x20 8680746480827		
	20x25 8680746480834		

## PU SEAL 600 - 2100

POLYURETHANE BASED MASTIC



PACK	600 ml 24'lü koli 300 ml 25'li koli	CONSUME	1,00 dm <sup>3</sup> /dm <sup>3</sup>
BARKOD	 8680746480872		

### DESCRIPTION:

- Polyurethane based moisture cement joint filling mastic.

### USAGE AREAS:

- Impermeability,
- Cement based construction materials,
- Brick, ceramic, glass, wood,
- Perfect adhesion on galvanized sheet, painted sheet and more plastic products's surface
- Suitable use for aluminium, PVC and woodworks joints & assembly.

### ADVANTAGES:

- Cured with moisture,
- UV resistance.
- Paintable surface.
- It is applied by matic gun,



## PU SEAL PRO 2K - 2200

TWO COMPONENT,POLYURETHANE BASED MASTIC



	A	B	TOPLAM
PACK	8.00 kg	4.00 kg	12.00 kg
CONSUME	1,40 kg / dm <sup>3</sup>		
BARKOD	 8680746480889		

### DESCRIPTION:

- Two component, polyurethane based pourable mastic.

### ADVANTAGES:

- Solvent free.
- UV resistance.
- Paintable surface.
- Can be applied as pouring on the wide joints.

### KULLANIM ALANLARI:

- Impermeability,
- Wide dilatations,
- Cement based construction materials,
- Brick, ceramic, glass, wood,
- Perfect adhesion on galvanized sheet, painted sheet and more plastic products's surface
- Suitable use for aluminium, PVC and woodworks joints & assembly

## PU SEAL PR 150

POLYURETHANE BASED ABSORBENT SURFACE PRIMER

## PU SEAL PR 160

POLYURETHANE BASED NON-ABSORBENT SURFACE PRIMER



PACK	1.00 kg 4.00 kg	CONSUME	0.050 Kg/m²
BARKOD	 8680746480896	 8680746480902	





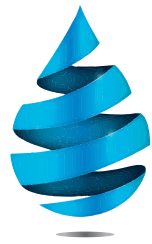

# Dayman®

Teknik Yapı Kimyasalları



**SPECIAL  
PAINTS**



PACK	18.00 kg	CONSUME	0,400 kg / m <sup>2</sup> – 0,800 kg / m <sup>2</sup>
BARKOD	 8680746480919		



### AQUAWALL - 606

#### EXTERIOR WALL WATERPROOF INSULATION PAINT

##### DESCRIPTION:

- UV resistance, elastomeric, acrylic resin based, single component, spreadable exterior wall waterproofing product.

##### USAGE AREAS:

- Used exterior parts of the all buildings.

##### ADVANTAGES:

- Decorative and estetic .
- Very high flexibility.
- High grade bridging of the cracks.
- Very high adherence.
- Easy and fast application.
- Applied by spreadble brush .
- Ultra high resistant to temperature differences due to elastomeric property.
- 1300 % elastic.
- Creates a waterproofing layer without joints, seamless, permanent, moisture and waterproof.
- Has strong penatation.



## MOLD PAINT - 609

ANTI MOLD / MOLD PAINT



### DESCRIPTION:

- Mold paint 609 is a very strong insulation paint, waterproof, acrylic emulsion based, modified with special chemicals and polymers to remove moisture and mold problems which occurred naturally on the inner and outer walls.

### USAGE AREAS:

- Molding caused by condensation,
- Bath,
- Wc,
- Room,
- Kitchen,
- And used in same areas.

### ADVANTAGES:

- DAYMAN MOLD PAINT- 609 moisture paint, due to special chemical receipt that creates a water impermeable layer on the surface where it is applied, in the same time prevent the molding tinside of the wall.
- High adherence.
- Eaisy apply
- Environment friend.
- Easy .preaperatin.
- Water repellent.

PACK	18.00 kg 5.00 kg	CONSUME	0,150 – 0,300 kg/m <sup>2</sup>
BARKOD	 8680746480940		

## MOLD PAINT SOL – 621

IMPROVED SOLUTION FOR MOLD CLEANING



### DESCRIPTION:

- Special solids used to clean moldy surfaces.

### USAGE AREAS:

- DAYMAN MOLD PAINT- 609 used before mold paints to clean the moldy area.

### ADVANTAGES:

- Clean the moldy areas.
- Prevent new mold formation.

PACK	0.50 kg	CONSUME	0,300 – 0,500 kg/m <sup>2</sup>
BARKOD	 8680746481046		



## GUARD FIRE - 610

FIRE PROTECTION DYE WHICH SWELLS WITH FLAME



### DESCRIPTION:

- It is a paint that protects against fire by its special formulation in comparison with flame.

### USAGE AREAS:

- Concrete,
- Mortar,
- Plaster,
- Wood,
- Steel surface protection.

### ADVANTAGES:

- It adheres perfectly to all kinds of surfaces.
- Has high covering power.
- High adherence.
- Provides up to 120 minutes of protection.
- Provides fire insulation by expansion.
- It forms a seamless layer by drying on the applied surface.
- Excellent flame retardancy,
- During the fire,takes a swell form to not increase the flame to critical points.
- It is very convenient to use in wood, concrete, prefabricve and steel structure.

PACK	18.00 kg 5.00 kg	CONSUME	1,00 – 1,50 Kg/m <sup>2</sup>
BARKOD	 8680746480957		
	 8680746481336		





## FLOOR PAINT – 611

FLOOR PAINT APPLIED IN MINERAL SURFACE



PACK	18.00 kg 5.00 kg	CONSUME	0,300 – 0,500 kg/m²
BARKOD	 8680746480964		

### DESCRIPTION:

- Waterproof, acrylic emulsion based, silicate additive, concrete, screed, paving stone etc. single component color for porous surfaces, unaffected by outside weather, high abrasion resistance, fast drying and durability properties.

### USAGE AREAS:

- Concrete, screed and paving stone,
- Indoor & outdoor applications,
- Warehouse and facilities,
- Shopping center, super market,
- Warehouse floor,
- Turistic areas, bicycle streets, coast line, pedestrian streets, squares, parks and gardens.

### ADVANTAGES:

- Has high covering power..
- Rain and water resistant.
- Muddy, environmental friend.
- Has high mechanical strength.
- Does not become yellow and fade by the time,
- Resistant to abrasion.
- It is not affected by human and vehicle traffic.
- Ultra high water vapor permeability.
- Can be used on vertical and horizontal surfaces.
- Solvent free.
- Dry in a short time.
- It perfectly covers the surface homogeneously.
- Quickly applied.



## FLOOR PAINT X – 622

SOLVENTAL FLOOR PAINT TO USE IN MINERAL SURFACES



PACK	18.00 kg	CONSUME	0,300 – 0,500 kg/m²
BARKOD	 8680746481350		

### DESCRIPTION:

- Including solvent, acrylic emulsion based, concrete, screed, paving stone etc. single component color for porous surfaces, unaffected by outside weather, high abrasion resistance, fast drying and durability properties.

### USAGE AREAS:

- Concrete, screed and paving stone,
- Indoor & outdoor applications,
- Warehouse and facilities,
- Shopping center, super market,
- Warehouse floor,
- Turistic areas, bicycle streets, coast line, pedestrian streets, squares, parks and gardens.

### ADVANTAGES:

- Has high covering power..
- Rain and water resistant.
- Muddy, environmental friend.
- Has high mechanical strength.
- Does not become yellow and fade by the time,
- Resistant to abrasion.
- It is not affected by human and vehicle traffic.
- Ultra high water vapor permeability.
- Can be used on vertical and horizontal surfaces.
- Solvent free.
- Dry in a short time.
- It perfectly covers the surface homogeneously.
- Quickly applied.



## ROAD PAINT – 612

### ROAD LINE PAINT



PACK	18.00 kg	CONSUME	0,500 – 0,700 kg/m <sup>2</sup>
BARKOD	 8680746480971		

#### DESCRIPTION:

- It is water based, acrylic emulsion based, solvent free, road line paint.

#### USAGE AREAS:

- Concrete, screed and paving stone,
- Indoor & outdoor applications,
- Warehouse and facilities,
- Shopping center, super market,
- Warehouse flooe,
- Turistic areas, bicycle streets, coast line, pedestrian streets, squars, parks and gardens.



#### ADVANTAGES:

- Has high covering power.
- Rain and water resistant.
- Muddy, environmental friend.
- Has high mechanical strength.
- Does not become yellow and fade by the time,
- Resistant to abrasion.
- It is not affected by human and vehicle traffic.
- Ultra high water vapor permeability.
- Can be used on vertical and horizontal surfaces.
- Solvent free.
- Dry in a short time.
- It perfectly covers the surface homogeneously.
- Quickly applied.



## COURT PAINT – 613

### TENİS KORTU BOYASI



PACK	18.00 kg	CONSUME	0,300 – 0,500 kg/m <sup>2</sup>
BARKOD	 8680746480988		

#### DESCRIPTION:

- It is water based, acrylic emulsion based, solvent free, UV resistant tennis court paint.

#### USAGE AREAS:

- Tennis court,
- Sport areas,
- Parks,
- School gardens and walking streets ,
- Shopping centers, super markets.

#### ADVANTAGES:

- Ultra UV resistant.
- Dirt - resistant.
- Has high covering power.
- Rain and water resistant.
- Environmental friend.
- Has high mechanical strength.
- Does not become yellow and fade by the time,
- Resistant to abrasion.
- Solvent free.
- Dry in a short time.
- Quick and fast apply.



## THERMAL PAINT METAL - 614

LIQUID HEATING INSULATION,  
PAINT APPLIED ON METAL SURFACE



### DESCRIPTION:

- Water based, acrylic emulsion based, developed for mineral surfaces, high performance, low thermal conductivity value of ceramic microspheres, providing a thermal insulation on the interior and exterior surfaces.

### USAGE AREAS:

- On all metal surfaces,
- On hot or cold pipelines.

### ADVANTAGES:

- On hot or cold pipelines insulation.
- UV resistant,
- High adherence.
- Fast and quick apply.
- Can be applied with brush and spraying equipment.
- Strong penetration

PACK	18.00 kg	CONSUME	0,250 – 0,500 Kg/m <sup>2</sup>
BARKOD	 8680746480995		

## THERMAL PAINT CONCRETE - 620

LIQUID HEATING INSULATION,  
PAINT APPLIED ON METAL SURFACE



### DESCRIPTION:

- Water based, acrylic emulsion based, developed for mineral surfaces, high performance, low thermal conductivity value of ceramic microspheres, providing a thermal insulation on the interior and exterior surfaces.

### USAGE AREAS:

- Concrete, screed,platered surfaces,
- On cement coated surfaces,
- All the mineral surfaces,

### ADVANTAGES:

- In the building for the heating and cooling energy costs, it provides 30-35% energy saving depending on the application coefficient.
- When used as wall and ceiling paint, reflects the radyan heating to inside.
- When used on the exterior walls, the sun's rays are reflected to put back by the incoming radiant heat.
- UV resistant.
- High adherence.
- Fast and quick apply.
- Can be applied with brush and spraying equipment.
- Strong penetration.

PACK	18.00 kg	CONSUME	0,250 – 0,500 Kg/m <sup>2</sup>
BARKOD	 8680746481008		

## D-NANO 615

WATER BASED,TRANSPARENT WATER REPELLENT IMPEGNATED PRODUCT



### DESCRIPTION:

- Water based, acrylic emulsion based, waterproof product for exterior walls.

### USAGE AREAS:

- Mortar,
- Concrete,
- Natural stone,
- Gas concrete ect. Absorber surface,

### ADVANTAGES:

- Due to the silicone resin content, it gives very strong water repellent property.
- Removes problems like salt vomiting.
- Reduce the dirtiness.
- Provides concrete protection.
- Due to its transparency, it does not disturb the natural appearance.
- Increase soil adherence with paint to be coated on it.
- Easy to apply.
- Water vapor permeable.



PACK	30.00 kg 5.00 kg	CONSUME	0,200 – 0,700 kg /m <sup>2</sup>
BARKOD	30.00 kg  8680746481015	5.00 kg  8680746481343	

## MOLD OIL - 616

MOLD SPERATOR OIL



### DESCRIPTION:

- Mold Oil 616 Mineral oil based, mold separate product. It prevents adhesion between fresh concrete and mould.

### USAGE AREAS:

- Wood
- Plywood,
- Plastic,
- Steel moulds

### ADVANTAGES:

- Ready for use.
- Fast and easy apply.
- Reduce the labor during the disassembly of the mould.
- As the mould not damaged it the can be used longer and efficient.
- Concrete become out extremely smooth.
- Mould cleaning can be done easier

PACK	30.00 kg	CONSUME	0,040 kg/m <sup>2</sup>
BARKOD	 8680746481022		

## LEVEL PR - 617

PRIMER FOR CEMENT BASED MORTAR



### DESCRIPTION:

- Cement based screed and mortar binding primer material used under coatings.

### USAGE AREAS:

- In vertical and horizontal places.
- Indoor and outdoor.
- Before screed.
- Before using repairmen mortar.

### ADVANTAGES:

- Forms a strong bond between old concrete and screed.
- Water impermeable.
- Resistant to freezing.
- Suitable use for indoor and outdoor.

PACK	30.00 kg	CONSUME	0,150 – 0,300 kg/m <sup>2</sup>
BARKOD	 8680746481053		

## ST PRIMER - 619

BRUT CONCRETE PLASTER

BAZALT TAKVİYELİ



### DESCRIPTION:

- Water and acrylic emulsion brut concrete plaster.

### USAGE AREAS:

- Before screed and plaster,
- Before cement based mortar,
- Vertical and horizontal places.

### ADVANTAGES:

- Increase the adherence of the plaster on concrete
- Increase the processing time of cement and especially gypsum plaster.
- Easy application.
- Prevents rapid water loss of the mortar.

PACK	12.00 kg	CONSUME	0,200 kg /m <sup>2</sup>
BARKOD	 8680746481039		











**ANCHOR INJECTION  
ACCESSORIES AND  
IMPLEMENTATION  
MATERIALS**

## BOND EPO PRO – 857

EPOXY BASED TWO COMPOUND CHEMICAL ANCHORAGE PRODUCT



PACK	A + B bileşenli 5 kg	CONSUME	1,70 kg/Lt
BARKOD	 8680746481084		

### DESCRIPTION:

Epoxy based, two components, chemical anchorage repairment and montage product.

### USAGE AREAS:

- Sprout implant and fixing screw,
- To montage and adhesion of the metal and steel materials,
- In the bonding and fixing of the construction elements,
- To fix aluminum joinery and railings,
- Provides the seal of cracks before injection,
- Adhesion of dilatation tapes.

### ADVANTAGES:

- Economic.
- Thixotropic, does not sag.
- Eaisy and fast application
- Fast result



## BOND EPO – 859

EPOXY BASED CHEMICAL ANCHOR PRODUCT



PACK	280 ml kartuş	CONSUME	1,70 kg/Lt
BARKOD	 8680746481077		

### DESCRIPTION:

- Epoxy based, two components chemical anchor products.

### USAGE AREAS:

- Sprout implant and fixing screw,
- Fixing and adhesion of the stone elements.
- Fixing of the aluminium joinery and strawman
- Provides the seal of cracks before injection,

### ADVANTAGES:

- Apply by gun.
- Thixotropic, does not sag.
- Eaisy and fast application
- Fast result

## BOND – 861

POLYESTER BASED CHEMICAL ANCHOR PRODUCT



PACK	280 ml kartuş	CONSUME	1,60 kg/Lt
BARKOD	 8680746481060		

### DESCRIPTION:

- Polyester based, two component chemical anchor product.

### USAGE AREAS:

- Sprout implant and fixing screw,
- Fixing and adhesion of the stone elements.
- Fixing of the aluminium joinery and strawman
- Provides the seal of cracks before injection,

### ADVANTAGES:

- Apply by gun.
- Thixotropic, does not sag.
- Eaisy and fast application
- Fast result

## CRACK POL WT - 815

POLYURETHANE BASED LOW VISCOSITY INJECTION RESIN.



### DESCRIPTION:

- Two components, low viscosity and is a closed-cell injection resin that reacts with water.

### USAGE AREAS:

- Ground works,
- Curtains,
- Retaining walls,
- Barrage,
- Waste water treatment facility,
- Cracked walls.

### ADVANTAGES:

- Reacts with water to cut off water.
- Solvent free.
- Easy apply.
- It is resistant to weak acids, microorganisms, alkalies and water.

	A	B	TOTAL
PACK	7.50 kg	0.750 kg	8.25 kg
CONSUME	0,100 Kg	BARKOD	
			8680746481091



## CRACK EPO - 816

EPOXY BASED LOW VISCOSITY INJECTION RESIN



### DESCRIPTION:

- Two component, low viscosity and injection resins that can be used in strengthening applications.

### USAGE AREAS:

- Ground works,
- Curtains,
- Retaining walls,
- Barrage,
- Waste water treatment facility,
- To strong the cracked walls.

### ADNATAGES:

- It is a strong connector.
- Fast result.
- Solvent free.
- Easy apply.
- It is resistant to weak acids, microorganisms, alkalies and water.

	A	B	TOTAL
PACK	10.00 kg	5.00 kg	15.00 kg
CONSUME	1,00 Kg	BARKOD	
			8680746481121

## PACKER - 70 - 120

INJECTION PIN



### DESCRIPTION:

Injection pin for polyurethane and epoxy injection resins.

### USAGE AREAS:

- Can be applied in polyurethane and epoxy resin.

### ADNATAGES:

- Economic.
- Easy apply.

	PACK	CONSUME	
	14 mm	70 - 120 mm	
BARKOD			8680746481107
			8680746481114

## LEVEL PR - 617

BOND 858 VE BOND EPO APPLICATION GUN



### DESCRIPTION:

- DAYMAN BOND 858 ve DAYMAN BOND EPO application gun.

### USAGE AREAS:

- In anchorage applications
- To fill the crack before injection

### ADNATAGES:

- Easy and fast use.
- It is extremely harmonious with DAYMAN BOND 858 ve DAYMAN BOND EPO.
- Serve long time.

	PACK	
	1 adet	
BARKOD		8680746481145

## PU GUN - 1000

Пистолет для нанесение герметика PU SEAL



### DESCRIPTION:

- PU SEAL to use mastic apply gun.

### USAGE AREAS:

- For use in mastic apply.

### ADNATAGES:

- Durable against bumps
- Provides ease of application
- Pratic use

	PACK	
	1 adet	
BARKOD		8680746481152







Handwriting practice lines consisting of 24 horizontal rows. Each row is defined by two thin brown lines, with a light gray shaded band in the center of each row.







[www.dayman.com.tr](http://www.dayman.com.tr)



**Head Office:**

Konak Mahallesi, Lefkoşe Cd. No:42,  
Origami Flat Office Kat 2 No: 28  
16110 Nilüfer / Bursa / TÜRKİYE

**Fabric:**

Uludağ Organize San.Bölg.  
Sahra cad. No:6/B  
Gürsu /BURSA TÜRKİYE

**0 850 532 55 16**

[info@dayman.com.tr](mailto:info@dayman.com.tr)